

# LawnMaster®

## Operator's Manual

EN p. 2

Chipper FD1501

Save this manual for future reference

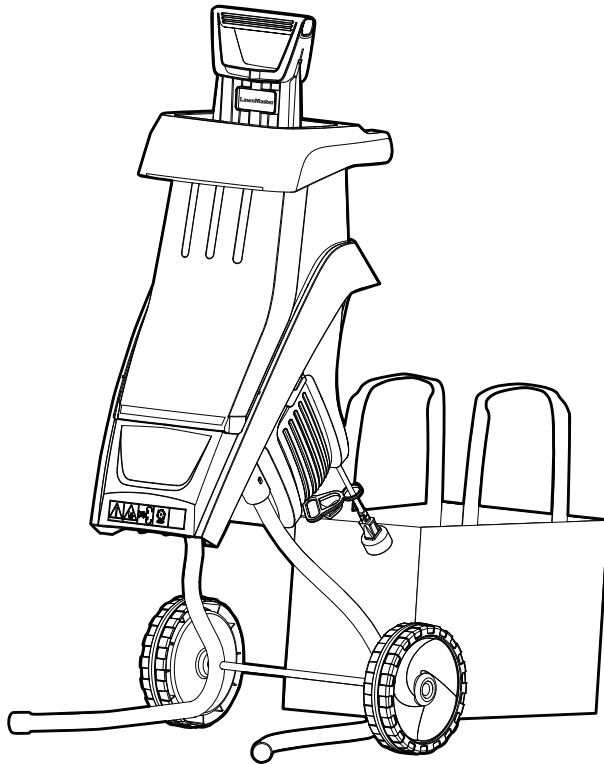

Read all safety rules and instructions carefully before operating this tool.  
Distributed By: Suzhou Cleva Electric Appliance Co., Ltd.  
NO.8 Ting Rong Street 215122 Suzhou - China



# TABLE OF CONTENTS

---

<b>Section</b>	<b>Page</b>
TABLE OF CONTENTS	2
SPECIFICATIONS	3
IMPORTANT SAFETY INSTRUCTIONS	4-8
SYMBOLS	9-10
KNOW YOUR CHIPPER	11
ASSEMBLY	12-14
OPERATION	15-18
MAINTENANCE	19-21
TROUBLESHOOTING	22
LAWNMASTER® WARRANTY	23
EXPLODED VIEW	24
PARTS LIST	25
NOTES	26-27

# SPECIFICATIONS

---

## CHIPPER FD1501

Nominal Current	15 A
Nominal Voltage	120 V~60 Hz
Speed	3800 rpm
Maximum Cutting Diameter	1-1/2" (38 mm)
Volume Of Collection Bag	15.85 gal
Weight	29.75 lbs (13.5 kg)

**NOTE:** The max. branch thickness that can be chipped is dependent on the type of wood and the quality of the goods being cut, but never thicker than 1-1/2" in diameter.

For hard wood (e.g. oak/beech branches), the max. branch thickness that can be chipped is less than for soft wood (e.g. pine/spruce wood). For dry or knotted wood, the cutting thickness may also be less.

This chipper is designed for dry material only. Never place green material or bamboo into the chipper.

# IMPORTANT SAFETY INSTRUCTIONS

---



## WARNING

### READ AND UNDERSTAND ALL INSTRUCTIONS.

Failure to follow all instructions listed below may result in electric shock, fire and/or serious personal injury:

---



## WARNING

To avoid mistakes that could cause serious injury, do not plug in the chipper until the following steps have been read thoroughly.

---

- Avoid Dangerous Environment – Don't use appliances in damp or wet locations.
- Don't Use In Rain.
- Keep Children Away – All visitors should be kept at a distance from work area.
- Dress Properly – Do not wear loose clothing or jewelry. They can be caught in moving parts. Use of rubber gloves and substantial footwear is recommended when working outdoors. Wear protective hair covering to contain long hair.
- Use Safety Glasses – Always use face or dust mask if operation is dusty.
- Use Right Appliance – Do not use appliance for any job except that for which it is intended.
- Ground Fault Circuit Interrupter (GFCI) protection should be provided on the circuit(s) or outlet(s) to be used for the gardening appliance. Receptacles are available having built-in GFCI protection and may be used for this measure of safety.
- Warning – To reduce the risk of electric shock, use only with an extension cord intended for outdoor use, such as an extension cord of cord type SW-A, SOW-A,STW-A, STOW-A, SJW-A, SJOW-A, SJTW-A or SJTOW-A.
- Extension Cord – Make sure your extension cord is in good condition. When using an extension cord, be sure to use one heavy enough to carry the current your product will draw. An undersized extension cord will cause a drop in line voltage resulting in loss of power and overheating. If in doubt, use the next heavier gage. The smaller the gage number, the heavier the cord. To reduce the risk of disconnection of appliance cord from the extension cord during operating:
  - i. Make a knot; or
  - ii. Use one of the plug-receptacle retaining straps or connectors described in this manual.
- Avoid Unintentional Starting – Don't carry plugged-in appliance with finger on switch. Be sure switch is off when plugging in.
- Don't Abuse Cord – Never carry appliance by cord or yank it to disconnect from receptacle. Keep cord from heat, oil, and sharp edges.
- Don't Force Appliance – It will do the job better and with less likelihood of a risk of injury at the rate for which it was designed.
- Don't Overreach – Keep proper footing and balance at all times.
- Stay Alert – Watch what you are doing. Use common sense. Do not operate appliance when you are tired.
- Disconnect Appliance – Disconnect the appliance from the power supply when not in use, before servicing, when changing accessories such as blades, and the like.

# IMPORTANT SAFETY INSTRUCTIONS

---

- Store Idle Appliances Indoors – When not in use, appliances should be stored indoors in dry, and high or locked-up place out of reach of children.
- Maintain Appliance With Care – Keep cutting edge sharp and clean for best performance and to reduce the risk of injury. Follow instructions for lubricating and changing accessories. Inspect appliance cord periodically, and if damaged, have it repaired by an authorized service facility. Inspect extension cords periodically and replace if damaged. Keep handles dry, clean, and free from oil and grease.
- Check Damaged Parts – Before further use of the appliance, a guard or other part that is damaged should be carefully checked to determine that it will operate properly and perform its intended function. Check for alignment of moving parts, binding of moving parts, breakage of parts, mounting, and any other condition that may affect its operation. A guard or other part that is damaged should be properly repaired or replaced by an authorized service center unless indicated elsewhere in this manual.
- When servicing, use only identical replacement parts.
- To reduce the risk of electric shock, this appliance has a polarized plug (one blade is wider than the other) and will require the use of a polarized extension cord. The appliance plug will fit into a polarized extension cord only one way. If the plug does not fit fully into the extension cord, reverse the plug. If the plug still does not fit, obtain a correct polarized extension cord. A polarized extension cord will require the use of a polarized wall outlet. This plug will fit into the polarized wall outlet only one way. If the plug does not fit fully into the wall outlet, reverse the plug. If the plug still does not fit, contact a qualified electrician to install the proper wall outlet. Do not change the equipment plug, extension cord receptacle, or extension cord plug in any way.
- Always wear eye protection. A yard chipper can throw foreign objects into your eyes which could cause permanent eye damage. ALWAYS wear safety goggles (not glasses). Ordinary eyeglasses have only impact-resistant lenses. They are NOT safety goggles.

## SPECIFIC SAFETY INSTRUCTIONS FOR YARD CHIPPERS

- Be thoroughly familiar with the operation of the chipper before initial use.
- NEVER put your hands into the hopper. Always use the push paddle supplied with your chipper to push items into the hopper.
- DO NOT try to force objects that exceed the recommended diameter and capacity of the chipper: 1-1/2" (38 mm).
- AVOID ACCIDENTAL START-UPS. Be sure switch is OFF when plugging in.
- DO NOT FORCE THE CHIPPER. It will do the job better and with less likelihood of injury at the rate for which it was designed.
- Before putting objects into the hopper, remove any stones, debris, or objects that could damage the blades.
- During operation, ensure that there are no other persons or animals within a radius of 50 feet. Stop using the machine while people, especially children, or pets, are nearby.
- NEVER reach under the chipper until it has completely stopped. The blade may continue to rotate for a time after being switched OFF.
- MAKE all adjustments with the power OFF and the chipper disconnected from the power source.
- ALWAYS use accessories provided or recommended by the manufacturer. Do not use substitutes.
- KEEP guards in place and in working order. Keep blades sharp. Keep hands and feet away from cutting areas.

# IMPORTANT SAFETY INSTRUCTIONS

---

## **WARNING**

Never place hands near discharge chute. Failure could result in serious Injury.

---

## **WARNING**

Never reach into the hopper until the chipper has come to a complete stop and is unplugged. The chipper will continue to rotate for a few seconds after it is switched off.

---

## ELECTRICAL INFORMATION

---

## **WARNING**

**TO AVOID ELECTRICAL HAZARDS, FIRE HAZARDS, OR DAMAGE TO THE TOOL, USE PROPER CIRCUIT PROTECTION. YOUR CHIPPER IS WIRED AT THE FACTORY FOR 120V OPERATION. CONNECT TO A 120 V, 15 A CIRCUIT, AND USE A 15 A CIRCUIT BREAKER. TO AVOID SHOCK OR FIRE, IF THE EXTENSION CORD IS WORN, CUT OR DAMAGED IN ANY WAY, REPLACE IT IMMEDIATELY.**

---

## DOUBLE INSULATED

This yard chipper has a plug that looks like the one as shown below. The chipper is double insulated to provide a double  thickness of insulation between you and the tool's electrical system. All exposed metal parts are isolated from the internal metal motor components with protective insulation.

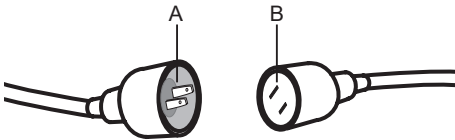

- A. 2-prong plug
- B. Properly grounded extension cord

## **WARNING**

**USE ONLY IDENTICAL REPLACEMENT PARTS WHEN SERVICING THE CHIPPER TO AVOID INJURY.**

---

# IMPORTANT SAFETY INSTRUCTIONS

---



## WARNING

DOUBLE INSULATION DOES NOT TAKE THE PLACE OF NORMAL SAFETY PRECAUTIONS WHEN OPERATING THIS TOOL.

---



## CAUTION

ALWAYS MAKE SURE THAT YOUR OUTLET IS PROPERLY GROUNDED. IF UNCERTAIN, HAVE IT CHECKED BY A CERTIFIED ELECTRICIAN.

---



## WARNING

THIS LAWN TOOL IS FOR OUTDOOR USE ONLY. DO NOT EXPOSE TO RAIN OR USE IN DAMP LOCATIONS.

---

### GUIDELINES FOR USING EXTENSION CORDS

USE THE PROPER EXTENSION CORD. Make sure your extension cord is in good condition. When using an extension cord, be sure to use one heavy enough to carry the current your product will draw. An undersized cord will cause overheating. The table below shows the correct size to use depending on cord length and nameplate ampere rating. If in doubt, use the next heavier gauge. The smaller the gauge number, the heavier the cord.

**Minimum Gauge for Extension Cords (AWG)  
(Using 120 V only)**

120V		Total Length of Cord in Feet (meters)			
		25ft (7.62m)	50ft (15.24m)	100ft (30.48m)	150ft (45.72m)
Ampere Rating		AWG			
More Than	Not More Than				
0	6	18	16	16	14
6	10	18	16	14	12
10	12	16	16	14	12
12	16	14	12	Not Recommended	

# IMPORTANT SAFETY INSTRUCTIONS

---

Make sure your extension cord is properly wired and in good electrical condition. Always replace a damaged extension cord or have it repaired by a qualified person before use. Keep extension cords away from sharp objects, excessive heat and damp or wet areas.

Use a separate electrical circuit for your tools. This circuit should comprise a wire of at least 12 gauge and should be protected with a 15 A time-delayed fuse. Before connecting the motor to the power line, make sure the switch is in the OFF position and the electric current is identical to that stamped on the motor nameplate. Running at a lower voltage will damage the motor.



## **WARNING**

**ALTHOUGH THIS CHIPPER IS DOUBLE INSULATED, THE EXTENSION CORD AND RECEPTACLE MUST STILL BE GROUNDED WHILE IN USE TO PROTECT THE OPERATOR FROM ELECTRICAL SHOCK.**

---









## **SAVE THESE INSTRUCTIONS**

Refer to them frequently and use them to instruct others who may use this tool. If you loan someone this tool, loan them these instructions also.



# SYMBOLS



Some of the following symbols may be used on this product. Please study them and learn their meaning. Proper interpretation of these symbols will allow you to operate the product better and safer.

SYMBOL	NAME	DESIGNATION/EXPLANATION
<b>V</b>	Volts	Voltage
<b>A</b>	Amperes	Current
<b>Hz</b>	Hertz	Frequency(cycles per second)
<b>W</b>	Watt	Power
<b>min</b>	Minutes	Time
~	Alternating Current	Type of current
---	Direct Current	Type or a characteristic of current
$\eta_0$	No Load Speed	Rational speed, at no load
	Class II Construction	Double-insulated construction
/min	Per Minute	Revolutions, strokes, surface speed, orbits etc., per minute
	Wet Conditions Alert	Do not expose to rain or use in damp locations.
	Read The Operator's Manual	To reduce the risk of injury, user must read and understand Operator's Manual before using this product.
	Eye Protection	Wear eye protection when operating this equipment.
	Ricochet	Thrown objects can ricochet and result in personal injury or property damage.
	Sharp Blade	Danger – Keep hands and feet away from blade.
	Cutting Capacity	Cutting capacity: 1-1/2" (38 mm).
	Keep Bystanders Away	Keep all bystanders at least 50 ft. away.

# SYMBOLS

---

The following signal words and meanings are intended to explain the levels of risk associated with this product.

SYMBOL	SIGNAL	MEANING
	<b>DANGER</b>	Indicates an imminently hazardous situation, which, if not avoided, will result in death or serious injury.
	<b>WARNING</b>	Indicates a potentially hazardous situation, which, if not avoided, could result in death or serious injury.
	<b>CAUTION</b>	Indicates a potentially hazardous situation, which, if not avoided, may result in minor or moderate injury.
	<b>NOTICE</b>	(Without Safety Alert Symbol) Indicates a situation that may result in property damage.

## SERVICE

Service requires extreme care and knowledge and should be performed only by a qualified service technician. When servicing, use only identical replacement parts.

For troubleshooting or replacement, please call Customer Service for assistance (Toll free number 866-384-8432).

---

## **WARNING**

To avoid serious personal injury, do not attempt to use this product until you read thoroughly and understand completely the Operator's Manual.

If you do not understand the warnings and instructions in the Operator's Manual, do not use this product. Call Customer Service for assistance (Toll free number 866-384-8432).

---

---

## **WARNING**



The operation of any power tool can result in foreign objects being thrown into your eyes, which can result in severe eye damage. Before beginning power tool operation, always wear safety goggles or safety glasses with side shields and, when needed, a full face shield. We recommend Wide Vision Safety Mask for use over eyeglasses or standard safety glasses with side shields. Always use eye protection which is marked to comply with ANSI Z87.1.

---

# KNOW YOUR CHIPPER

The safe use of this product requires an understanding of the information on the product and in this Operator's Manual as well as a knowledge of the project you are attempting. Before use of this product, familiarize yourself with all operating features and safety rules.

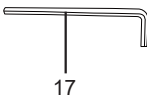
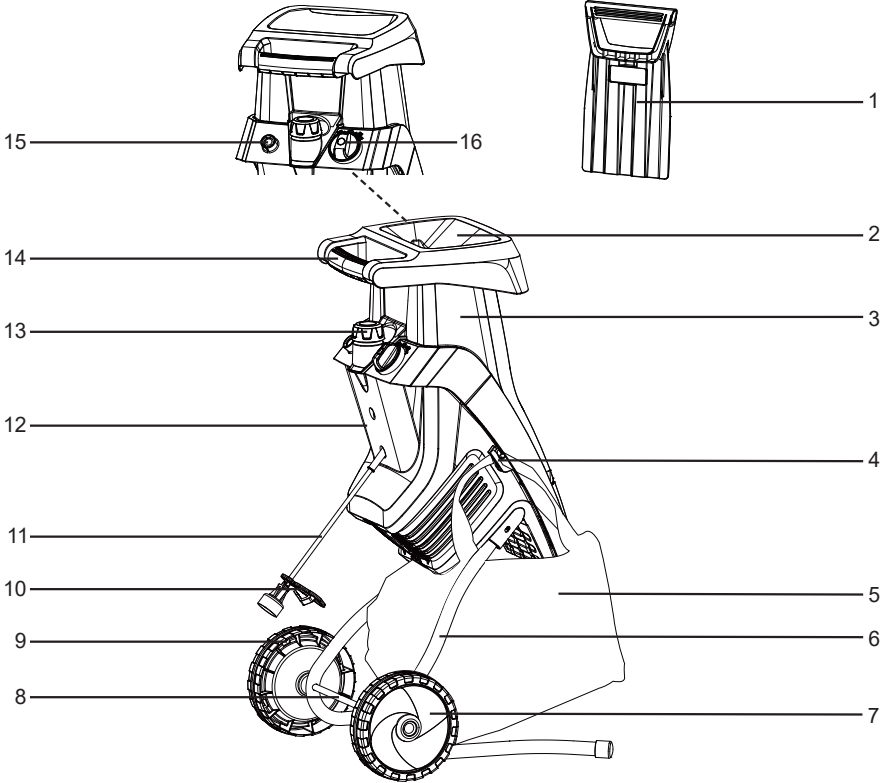

## Components

- |                                 |                               |   |
|---------------------------------|-------------------------------|---|
| 1. Push Paddle                  | 8. Axle                       | 15. Motor Reset Button                  |
| 2. Hopper Chute                 | 9. Wheel (X2)                 | 16. On/Off Switch                       |
| 3. Removable Upper Housing      | 10. Cord Retainer             | 17. Hex Key (Stored Inside the Chipper) |
| 4. Collection Bag Mounting Hook | 11. Power Cord                | 18. Screw (X2)                          |
| 5. Collection Bag               | 12. Lower Hopper Base Section | 19. Cotter Pin (X2)                     |
| 6. Chassis (X2)                 | 13. Hopper Locking Knob       | 20. Washer (X2)                         |
| 7. Hub Cap (X2)                 | 14. Handle                    |   |

# ASSEMBLY

---

## UNPACKING

This product requires assembly.

- Carefully remove the product and any accessories from the box. Make sure all items listed in the packing list are included.
- Inspect the product carefully to make sure no breakage or damage occurred during shipping.
- Do not discard the packing material until you have carefully inspected and satisfactorily operated the product.
- If any parts are damaged or missing, please call Customer Service (Toll free number 866-384-8432).

## YOU WILL NEED (ITEMS NOT SUPPLIED)

- Suitable Personal Protective Equipment
- Wrench
- Phillips screwdriver

## PACKING LIST

- (1) Chipper Unit
- (1) Push Paddle
- (2) Hub Caps
- (2) Wheels
- (2) Chassis
- (1) Axle
- (2) Washers
- (2) Cotter Pins
- (2) Screws
- (1) Collection Bag
- (1) Hex Key (Stored Inside the Chipper)
- (1) Operator's Manual



## WARNING

If any parts are damaged or missing, do not operate this product until the parts are replaced. Failure to pay attention to this warning could result in serious personal injury.

---

# ASSEMBLY

---

## **WARNING**

Do not attempt to modify this product or create accessories not recommended for use with this product. Any such alteration or modification is misuse and could result in a hazardous condition leading to possible serious personal injury.

---

## **WARNING**

Do not connect to power supply until assembly is complete. Failure to comply could result in accidental starting and possible serious personal injury.

---

## **WARNING**

Never operate the chipper without the proper safety devices in place and in correct working order. Never operate the chipper with damaged safety devices. Failure to pay attention to this warning can result in serious personal injury.

---

### ASSEMBLING THE CHASSIS AND WHEELS

- Lay the chipper unit on its side.
- Insert the 2 chassis into the 2 holes on the chipper housing as shown. Make sure the small hole on the chassis is aligned with the small hole on the chipper housing (Fig. 1).
- Push the chassis firmly into place and secure with two screws provided using a Phillips screwdriver. Do not over-tighten the screws (Fig. 1).

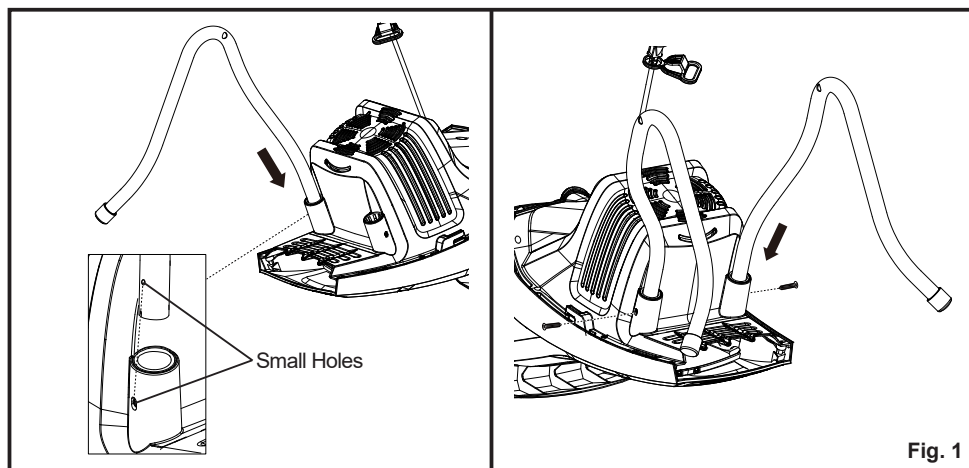

# ASSEMBLY

---

- Slide the axle through the 2 holes at the curves of chassis. Slide the two wheels onto the chassis axle. Place the washers onto the axle. Push straight end of the cotter pins into axle holes and press into holes until secured (Fig. 2).
- Align and push the two hub caps into place on both sides (Fig. 2).

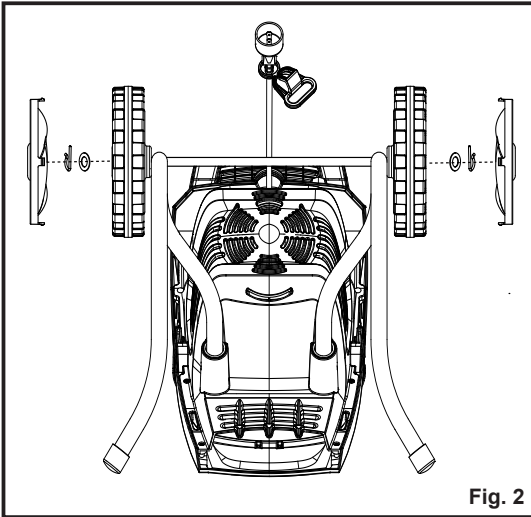

## ATTACHING THE COLLECTION BAG

Stand the chipper upright and hang the collection bag into the mounting hook as shown (Fig. 3).

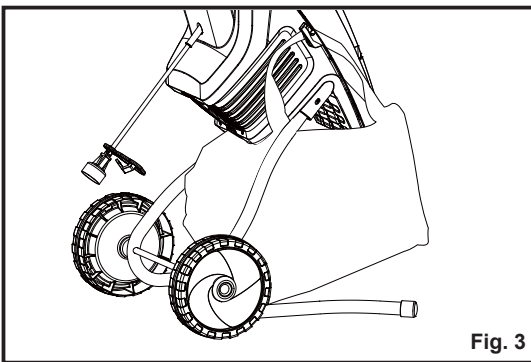

# OPERATION

---



## WARNING

Do not allow familiarity with this type of product to make you careless. Always pay attention when operating this product, not doing so can result in serious injury.

---



## WARNING

Always use protective equipment when working with the chipper. Do not use any attachments or accessories not recommended by the manufacturer of this product. The use of attachments or accessories not recommended can result in serious personal injury.

---



## WARNING

Keep proper balance and footing at all times. Do not overreach. Never stand at a higher level than the base of the machine when feeding material into it.

---

## CONNECTING TO POWER SUPPLY

This product is designed with a cord retainer that prevents the extension cord from being pulled loose during use.

- Form a loop with the end of the extension cord. From the right side, pass the loop through the hole in the back of cord retainer and place it around the hook (Fig. 4).
- Slowly pull the loop against tab until all slack is removed.
- Attach the outlet end of the extension cord to the plug on the rear of the chipper's power cord.

**NOTE:** Use only an approved outdoor extension cord as described previously in this manual.

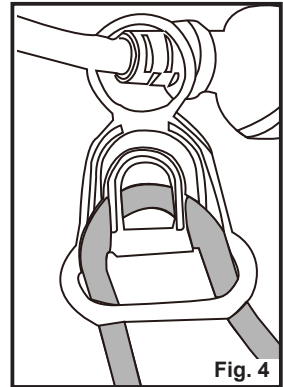

## STARTING/STOPPING THE CHIPPER

**NOTE:** Make sure that the hopper chute is empty before starting. Starting the hopper when full may result in the machine jamming.

- Plug the chipper into a grounded 2-prong outlet.
- Turn the On/Off switch to the ON position. If the chipper does not start, turn the switch to the OFF position and press the motor reset button, then turn the switch to the ON position (Fig. 5).

# OPERATION

---

- Turn the On/Off switch to the OFF position to turn off the chipper. Allow at least 5 seconds for the blade to stop rotating (Fig. 5).

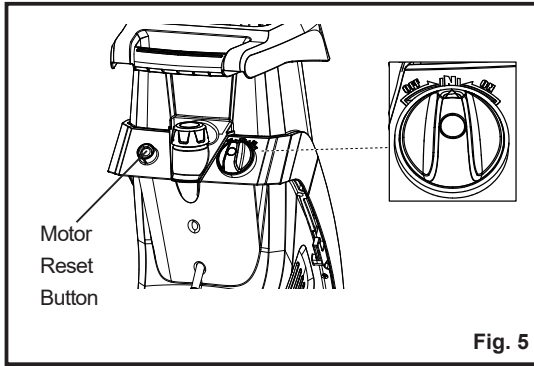

## USING YOUR CHIPPER

The chipper is designed to work on yard waste, debris, sticks and twigs up to 1-1/2" (38 mm) in diameter. Only for dry branch chipping, not designed for leaves, vines, or bamboo. Chipped material will accumulate directly in collection bag.

**NOTE:** This chipper is designed for dry material only. Never place green material or bamboo into chipper.

- Turn ON the chipper.
- Place sticks/yard debris into narrow hopper opening. NEVER place your hands inside hopper.
- Use push paddle to help feed yard material into hopper (Fig. 6).
- Always turn chipper OFF and allow it to come to a complete stop.

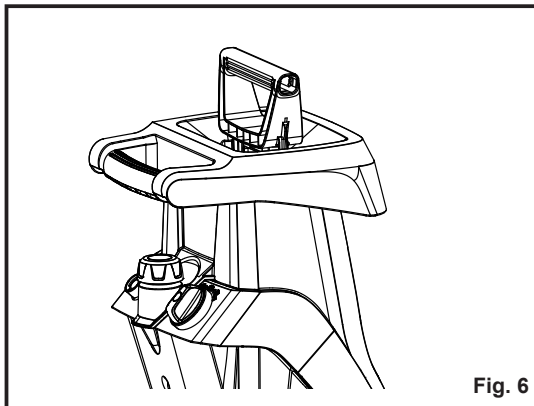



# OPERATION

---



## WARNING

Do not try to chip any material that exceeds the capacity of this tool. Doing so may cause the motor to jam and overheat. Never put your hands in the hopper or near the blade when the tool is running.

---



## WARNING

Always allow 5 seconds or more for the blade to a space between stop and rotating after turning off the chipper.

---

## EMPTYING THE COLLECTION BAG

---



## WARNING

Avoid filling the collection bag too much. Mind that the bag will fill unevenly under the discharge duct.

---

- Turn OFF the chipper.
  - Remove and empty the collection bag.
- 



## WARNING

Always switch off the chipper before emptying the collection bag.

---

## OVERLOAD PROTECTION

---



## WARNING

In the event of the chipper being overloaded, e.g. due to branches that are too thick, the chipper will automatically switch off.

---

This chipper has a reset overload feature. The reset button will restart the motor after it shuts off due to overloading or low voltage.

If the motor stops during operation:

- Turn the ON/OFF switch to the OFF position and unplug the chipper.
  - Wait a few minutes to let the motor cool down. Remove the blockages if necessary.
-

# OPERATION

---

- Plug the chipper back in. Press the reset button. Then turn ON the chipper (Fig. 7).

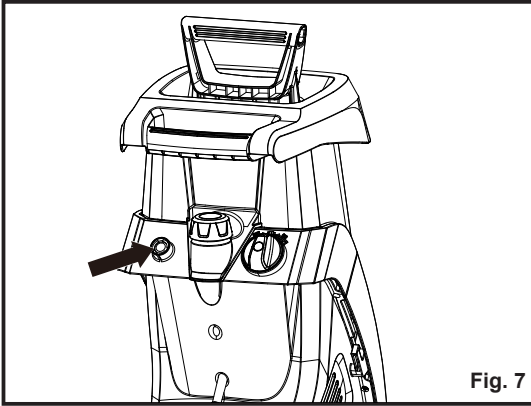

---

## **WARNING**

To prevent an accidental start-up if the reset button is pressed, the ON/OFF switch should be in the OFF position. The plug should be removed from the power source while cool down takes place.

---

# MAINTENANCE

---



## WARNING

Always switch the product off, disconnect it from the power supply and let the product cool down before performing maintenance.

---



## WARNING

Do not use any attachments or accessories that are not recommended by the manufacturer of this product. Using attachments or accessories not recommended can result in serious personal injury.

---



## WARNING

Always wear protective, heavy gloves and use protective safety equipment when performing blade maintenance. Ensure the power plug is disconnected from the power supply. Failure to pay attention to this warning could result in serious personal injury.

---

## GENERAL MAINTENANCE

- Keep the chipper clean and in good repair for maximum performance and longevity.
- Before each use, inspect the switch and cord for damage.
- Check for damaged, missing, or worn parts. Check for loose screws, moving parts that are jammed or any other conditions that may affect the operation.
- Do not spray water onto the chipper. Electric shock hazard.
- If abnormal vibration or noise occurs, turn the chipper OFF immediately and correct the problem before further use.
- Do not use the chipper until it is properly repaired or replaced. If necessary, call customer service for assistance.

## CLEANING AND STORAGE

---



## WARNING

To avoid injury, electric shock, or damage to the chipper, never allow liquid to flow inside the tool.

---

- Clean the chipper thoroughly before putting it away. Wipe the outside of the chipper with a dry soft cloth.
  - Remove the hopper from the housing body before cleaning the inside of the hopper.
  - Do not hose down or wash the tool with water.
  - Store the chipper in a safe, dry place well out of reach of children. Do not cover the chipper in nylon bags, as moisture may develop.
-

# MAINTENANCE



## WARNING

To avoid damage or electric shock, do not use strong solvents or detergents on the plastic housing or plastic components. Certain household cleaners may cause damage and may also cause a shock hazard.

### REVERSING & REPLACING THE BLADE

The chipper has a two-sided reversible blade that is attached to a rotating support plate. When one side of the blade becomes dull, it can be turned over in order to use the other side. Replace or properly sharpen any dull blade.

**NOTE:** ALWAYS handle the blade with care as it is sharp.

- Turn off the chipper and remove the power plug from the outlet.
- Unscrew the hopper locking knob counterclockwise until the housing cover can be opened (Fig. 8).
- Carefully lift up the upper housing cover to expose the 2 side reversible blade (Fig. 9).
- Use a screwdriver or wooden dowel (not provided) to secure the blade support. First, slot the screwdriver into the access hole as shown. Then carefully turn the blade support until one of the two blocking apertures appears and aligns with the access hole. Secure the blade support from rotating by slotting the screwdriver right through it (Fig. 9).

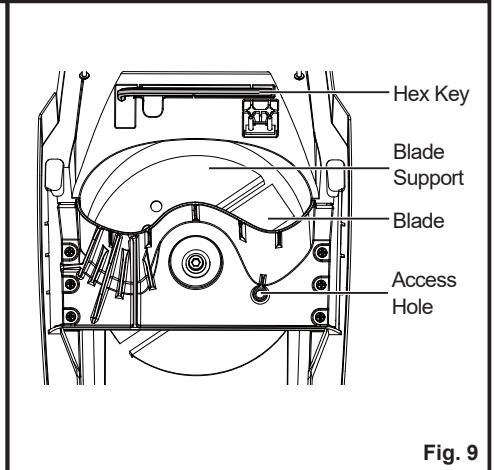
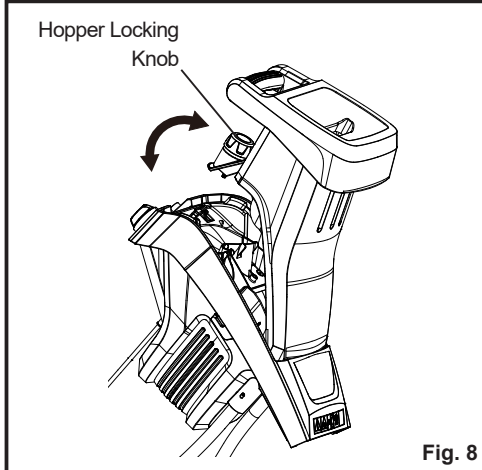

# MAINTENANCE

- Take out the hex key from the recess in the housing inside the chipper. Use the hex key to loosen the screw counterclockwise. Remove the screw and the washer. Remove the blade from the blade support (Fig. 10 & 11).
- The blade can be reversed with the sharp edge in position as the cutting surface, or replace any blunt or damaged blade as necessary.
- Insert the washer and the screw. Then use the hex key to tighten the screw clockwise to secure the blade to the blade support.
- Put the hex key to the recess for future use.
- Re-position the removable upper housing onto the lower hopper base section of the chipper. Secure them into place using the hopper locking knob.

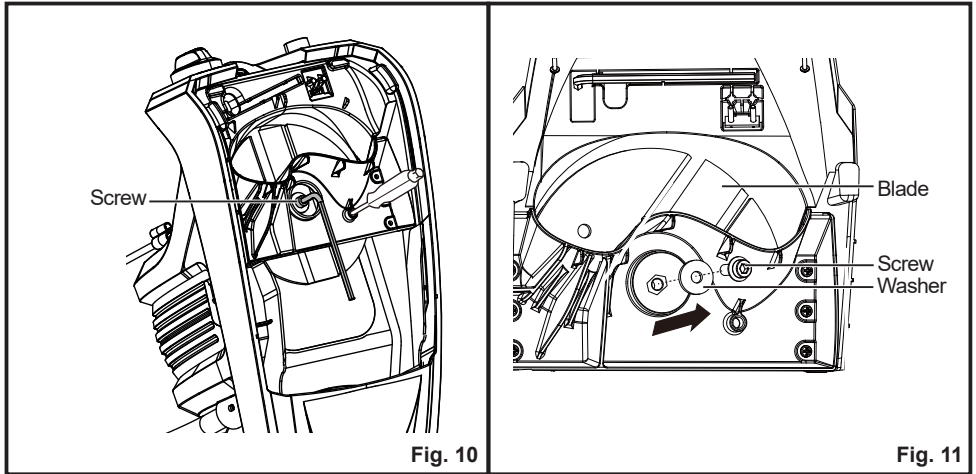

# TROUBLESHOOTING

---

Suspected malfunctions are often due to causes that the user can fix themselves.

Therefore, check the product using this section. In most cases the problem can be solved quickly.

---

## **WARNING**

Only perform the steps described within these instructions!

All further inspection, maintenance and repair work must be performed by an authorized service center or a similarly qualified specialist if you cannot solve the problem yourself!

Gloves and appropriate protective clothing must be worn when performing these instructions. Always turn off the machine, disconnect it from the power supply, and let the product cool down before making any adjustment.

---

PROBLEM	POSSIBLE CAUSE	SOLUTION
The chipper fails to start.	No power supply.	Check the socket, fuse, cable, wire and plug and have any repairs carried out by a qualified person.
	Overload protection tripped.	Wait until the motor has cooled down. Press the motor reset button, and then restart the chipper.
	Lid of chipper housing is not secured properly.	Tighten the hopper locking knob to secure the chipper housing.
Garden waste is not drawn in.	Chipping material is too soft.	Use the push paddle or add dry twigs/branches.
	Chipping material is in discharge duct.	Remove chipping material from discharge duct.
The chipper does not chip properly.	Blades are blunt.	Check the blades. Turn, or replace blades as necessary. Refer to REVERSING & REPLACING THE BLADE section on page 20.

# LAWNMASTER® WARRANTY

---

We take pride in producing a high quality, durable product. This Lawnmaster® product carries a limited two (2) year warranty against defects in workmanship and materials from date of purchase under normal household use. If product is to be used for commercial, industrial or rental use, a 30 day limited warranty will apply. Warranty does not apply to defects due to direct or indirect abuse, negligence, misuse, accidents, repairs or alterations and lack of maintenance. Please keep your receipt/packing list as proof of purchase. This warranty gives you specific legal rights, and you may have other rights, which vary from state to state. For product service call Customer Service at 1-866-384-8432.

Items not covered by warranty:

1. Any part that has become inoperative due to misuse, commercial use, abuse, neglect, accident, improper maintenance, or alteration;
2. The unit, if it has not been operated and/or maintained in accordance with the owner's manual;
3. Normal wear, except as noted below;
4. Routine maintenance items such as lubricants, blade sharpening;
5. Normal deterioration of the exterior finish due to use or exposure.

Transportation Charges: Transportation charges for the movement of any power equipment unit or attachment are the responsibility of the purchaser. It is the purchaser's responsibility to pay transportation charges for any part submitted for replacement under this warranty unless such return is requested in writing by LawnMaster®.

**SAVE YOUR RECEIPTS. THIS WARRANTY IS VOID WITHOUT THEM.**

# EXPLODED VIEW

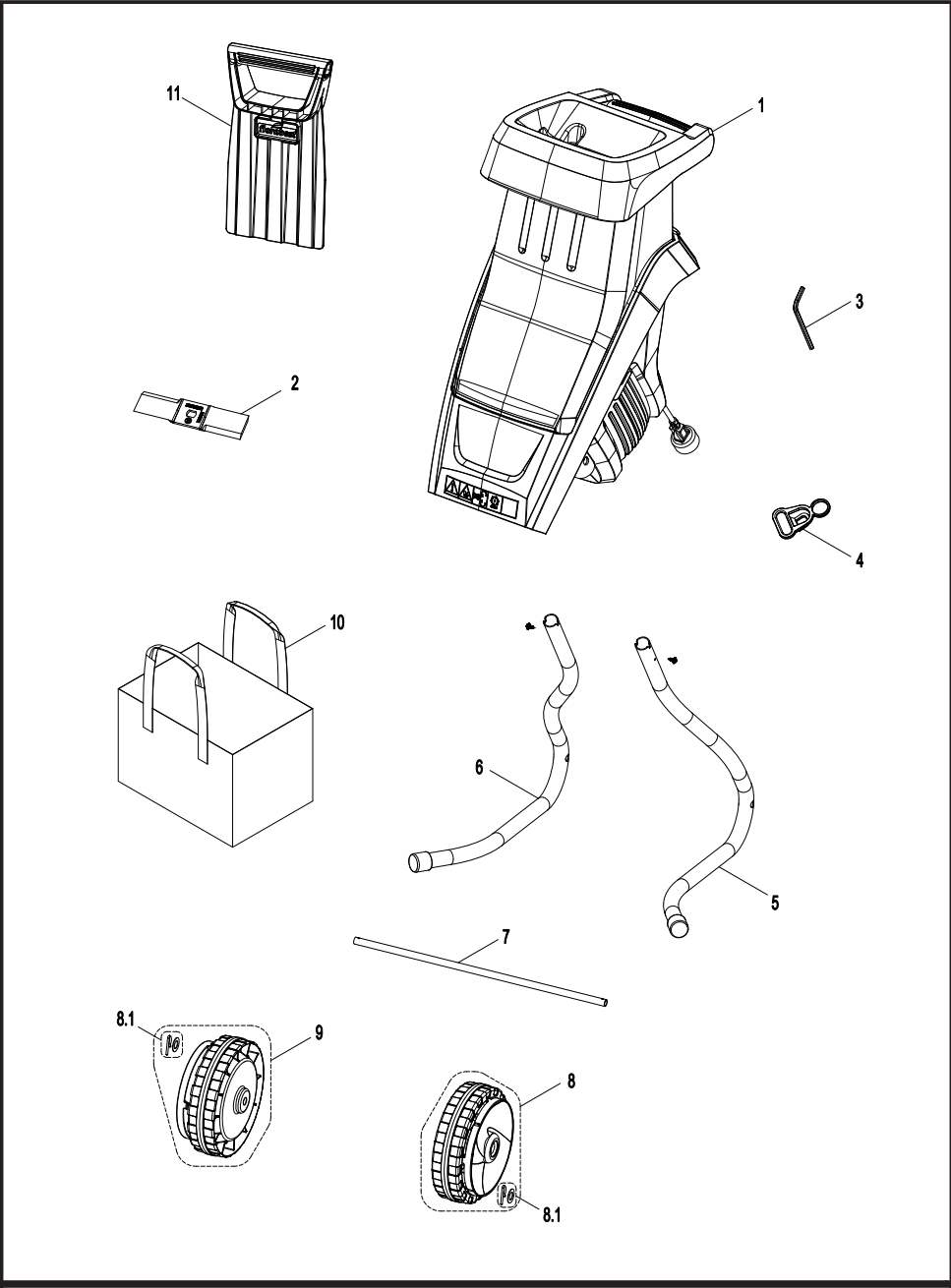



# PARTS LIST

---

Key Number	Part Number	Description	Quantity
1		Chipper Assembly	1
2	181042105	Blade	1
3		Hex Key	1
4		Cord Retainer	1
5		Left Chassis Assembly	1
6		Right Chassis Assembly	1
7		Wheel Axle	1
8		Large Wheel Assembly	1
8.1		Washer & Cotter Pin Accessory Kit	1
9		Large Wheel Assembly	1
10	181006116	Collection Bag	1
11	181042108	Push Paddle	1

Replacement parts highlighted in grey are available for after sales purchase. Replacement of repair or internal parts should only be done by a qualified service professional. Please contact your authorized service dealer or Customer Service at 866-384-8432.





