

LawnMaster®

Operator's Manual

18" 13.5 Amp Tiller TE1318W1 (MODEL: WR7025-1500-13.5-450H1)

Save this manual for future reference

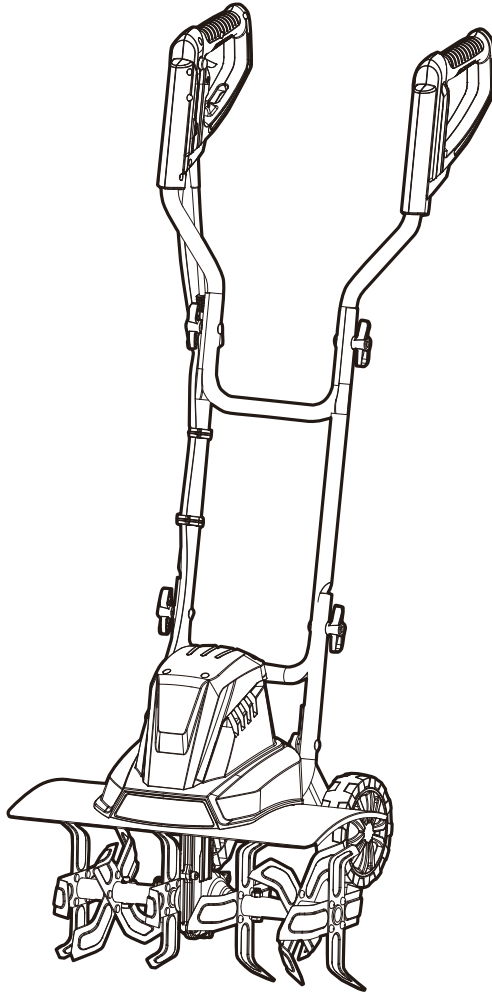

Read all safety rules and instructions carefully before operating this tool.



c TÜV Rheinland us

TABLE OF CONTENTS

Section	Page
TABLE OF CONTENTS	2
SPECIFICATIONS	2
IMPORTANT SAFETY INSTRUCTIONS	3-7
SYMBOLS	8-9
KNOW YOUR TILLER	10
ASSEMBLY	11-13
OPERATION	14-16
MAINTENANCE	17-20
TROUBLESHOOTING	21
LAWNMASTER® WARRANTY	22
EXPLODED VIEW	23-24
PARTS LIST	25-26
NOTES	27-28

SPECIFICATIONS

Model	WR7025-1500-13.5-450H1
Voltage	120 V ~ 60 Hz
Current	13.5 A
Motor Speed	390 RPM
Working Width	17.7 inch (450 mm)
Maximum Working Depth	8.6 inch (220 mm)
Number of Tines	6
Tine Diameter	8 inch (205 mm)
Unit Weight	24.03 lbs (10.9 kg)

IMPORTANT SAFETY INSTRUCTIONS



TO REDUCE RISK OF INJURY:

Before any use be sure everyone using this product reads and understands all safety instructions and other information contained in this manual.



CAUTION:

Wear appropriate personal hearing protection during use. Under some conditions and duration of use, noise from this product may contribute to hearing loss.



WARNING

When using electric gardening appliances, basic safety precautions should always be followed to reduce risk of fire, electric shock, and personal injury, including the following: **READ ALL INSTRUCTIONS.**

GENERAL SAFETY

- CHECK FOR DAMAGED PARTS - Before further use of the product, any part that is damaged should be carefully checked to determine that it will operate properly and perform its intended function. Check for alignment of moving parts, binding of moving parts, breakage of parts, mounting and any other condition that may affect its operation. Any part that is damaged should be properly repaired or replaced.
- AVOID DANGEROUS ENVIRONMENTS - Don't use this product in rainy, stormy, damp or wet locations. Do not operate in gaseous or explosive atmospheres. Motors in these products normally spark, and the sparks might ignite fumes.
- KEEP CHILDREN AWAY - All visitors, children and pets should stay at a safe distance from the work area.
- DRESS PROPERLY- Don't wear loose clothing or jewelry and wear protective hair covering to contain long hair. They can be caught in moving parts. Use of rubber gloves and substantial footwear is recommended when working outdoors.
- USE SAFETY GLASSES - Wear safety glasses with side shields or goggles when operating this product. Use face or dust mask if environment is dusty.
- DOUBLE INSULATION - The tiller has double insulation. This means that all external metal parts are insulated from the electrical supply. This is achieved by introducing an insulation layer between electrical and mechanical parts. The double insulation guarantees you the greatest possible safety.
- EXTENSION CORD. Make sure your extension cord is in good condition. When using an extension cord be sure it is heavy enough to carry the current your product will draw. An undersized extension cord will cause a drop in line voltage resulting in loss of power and overheating.

IMPORTANT SAFETY INSTRUCTIONS

- It is possible to tie the extension cord and power cord in a knot to prevent them from becoming disconnected during use. Make the knot as shown, then connect the plug end of the power cord into the receptacle end of the extension cord. This method can also be used to tie two extension cords together.



Minimum Gauge for Extension Cords (AWG) (Using 120V Only)

		Total Length of Cord in Feet (meters)			
120V		25ft (7.62m)	50ft (15.24m)	100ft (30.48m)	150ft (45.72m)
Ampere Rating		AWG			
More Than	Not More Than				
0	6	18	16	16	14
6	10	18	16	14	12
10	12	16	16	14	12
12	16	14	12	Not Recommended	

- Be aware of the extension cord while operating the tiller. Be careful not to trip on the cord. Always guide the cord away from the tines.
- Avoid Unintentional Starting - Don't carry plugged-in appliance with finger on switch. Be sure switch is off when plugging in. Don't grasp the exposed cutting tines or cutting edges when picking up or holding the appliance. Don't Force Appliance - It will do the job better and with less likelihood of a risk of injury at the rate for which it was designed. Keep hands away from tines.
- GROUND FAULT CIRCUIT INTERRUPTER (GFCI)
- Protection should be provided on the circuit or outlet to be used for the tiller. Receptacles are available having built-in GFCI protection and may be used.
- DISCONNECT UNIT from the power supply when not in use or when servicing or cleaning. Do not leave unattended.
- DON'T ABUSE CORD - Never carry this product by the cord or yank the cord to disconnect from the receptacle. Keep cord from heat, oil, and sharp edges.
- USE RIGHT APPLIANCE - Do not use this product for any job except that for which it is intended.
- DON'T OVERREACH - Guide the tiller at a walking pace only. Keep proper footing and balance at all times.
- LIGHTING - Only operate your tiller in daylight or good artificial light.
- STORE IDLE UNIT INDOORS - When not in use, the tiller should be stored indoors in a dry area

IMPORTANT SAFETY INSTRUCTIONS

out of children's reach.

- **MAINTAIN UNIT WITH CARE** - Keep clean for best performance and to reduce the risk of injury. Inspect extension cord periodically and replace if damaged. Keep handles dry, clean and free from oil.
 - **POLARIZED PLUGS** - To reduce the risk of electric shock, this product has a polarized plug. Polarized connections will fit together only one way. Make sure that the receptacle end of the extension cord has large and small blade slot widths. If the plug does not fit fully into the extension cord, reverse the plug. If it still does not fit, obtain a suitable extension cord. If the extension cord does not fit fully into the outlet, contact a qualified electrician to install the proper outlet. Do not change the plug on the tool or the extension cord in any way.
 - Do not operate the tiller on a slope that is too steep for safe operation. When on slopes, slow down and make sure you have good footing. Before starting the tiller make sure the tines are not touching any object and are free to move. Grip the guide bar firmly with both hands. Never operate the tiller with one hand.
-



CAUTION:

The tiller may bounce upward and/or jump forward if the tines strike extremely hard packed soil, frozen ground, or buried obstacles such as large stones, roots or stumps.

- **STAY ALERT** - Watch what you are doing. Use common sense. Do not operate the tiller when you are tired or under the influence of drugs or medication.
-



WARNING:

Do not operate the tiller near underground electrical cables, telephone lines, pipes or hoses. If the tiller strikes a foreign body, turn it off immediately, wait for the tines to stop and check for damage. If necessary, repair before restarting. If the tiller starts to vibrate abnormally, turn it off immediately and check for the cause. Vibration is generally a warning of trouble.



DANGER:

RISK OF CUT - Wear gloves and use caution when cleaning or performing maintenance on the tiller. Always turn off the tiller, disconnect from the power supply and wait until the tines come to a complete stop before carrying out any maintenance or repairs.



CAUTION:

Tines do not stop immediately after the tiller is turned off.

IMPORTANT SAFETY INSTRUCTIONS



WARNING:

The electrical cords on this product may contain chemicals known to the State of California to cause cancer and birth defects or other reproductive harm. Wash hands after handling.



WARNING:

Some dust and debris created by the use of this tool could contain chemicals known to the State of California to cause cancer and birth defects or other reproductive harm.

Some examples of these chemicals are:

- Chemicals in fertilizers
- Compounds in insecticides, herbicides, and pesticides
- Arsenic and chromium from chemically treated lumber

Your risk from exposure to these chemicals varies, depending on how often you do this type of work. To reduce your exposure, work in a well-ventilated area and with approved safety equipment such as dust masks that are specially designed to filter out microscopic particles.

Training

- Read the operating and service instruction manual carefully. Be thoroughly familiar with the controls and the proper use of the equipment. Know how to stop the unit and disengage the controls quickly.
- Never allow children to operate the equipment. Never allow adults to operate the equipment without proper instruction.
- Keep the area of operation clear of all persons, particularly small children, and pets.
- Keep in mind that the operator or user is responsible for accidents or occurring to other people, their property, and themselves.

Preparation

- Thoroughly inspect the area where the equipment is to be used and remove all foreign objects.
- Disengage all clutches and shift into neutral before starting the motor.
- Do not operate the equipment without wearing adequate outer garments. Wear protective footwear that will improve footing on slippery surfaces.
- Use extension cords and receptacles as specified by the manufacturer for all units with electric drive motors or electric starting motors.
- Never attempt to make any adjustments while the motor is running.

Operation

- Do not put hands or feet near or under rotating parts.
 - Exercise extreme caution when operating on or crossing gravel drives, walks, or roads. Stay alert for hidden hazards or traffic. Do not carry passengers.
 - After striking a foreign object, stop the motor, thoroughly inspect the machine for any damage, and repair the damage before restarting and operating the machine.
 - Exercise caution to avoid slipping or falling.
 - If the unit should start to vibrate abnormally, stop the motor and check immediately for the cause. Vibration is generally a warning sign of trouble.
 - Stop the motor when leaving the operating position, before unclogging the tines, and when making any repairs, adjustments, and inspections.
-

IMPORTANT SAFETY INSTRUCTIONS







- Take all possible precautions when leaving the machine unattended. Disengage the power take-off, lower the attachment, shift into neutral, stop the motor, and remove the key (if applicable).
- Before cleaning, repairing, or inspecting, shut off the motor and make certain all moving parts have stopped.
- Never operate the machine without proper guards, plates, or other safety protective devices in place.
- Keep children and pets away.
- Do not overload the machine capacity by attempting to till too deep at too fast a rate.
- Never operate the machine at high transport speeds on hard or slippery surfaces.
- Never allow bystanders near the unit.
- Use only attachments and accessories approved by the manufacturer of the machine (such as wheel weights, counterweights, and the like).
- Never operate the tiller without good visibility or light.
- Be careful when tilling in hard ground. The tines may catch in the ground and propel the tiller forward. If this occurs, let go of the handlebars and do not restrain the machine.
- Use extreme caution when reversing or pulling the machine towards you.
- Switch on the motor carefully according to instructions and with feet well away from the tines.
- Never pick up or carry a machine while the motor is running.
- Do not operate the tiller while under the influence of alcohol or drugs.

Maintenance and Storage

- Keep machine, attachments, and accessories in safe working condition.
- Check shear bolts, and other bolts at frequent intervals for proper tightness to be sure the equipment is in safe working condition.
- Always refer to the operator's manual for important details if the tiller is to be stored for an extended period.
- Follow manufacturer's recommendations for safe loading, unloading, transport, and storage of machine.



SYMBOLS

Some of the following symbols may be used on this product. Please study them and learn their meaning. Proper interpretation of these symbols will allow you to operate the product better and safer.

SYMBOL	NAME	DESIGNATION/EXPLANATION
V	Volts	Voltage
A	Amperes	Current
Hz	Hertz	Frequency (cycles per second)
W	Watts	Power
min	Minutes	Time
~	Alternating Current	Type of current
---	Direct Current	Type or a characteristic of current
n_0	No Load Speed	Rational speed, at no load
	Class II Construction	Double-insulated construction
/min	Per Minute	Revolutions, strokes, surface speed, orbits etc., per minute
	Wet Conditions Alert	Do not expose to rain or use in damp locations.
	Read the Operator's Manual	To reduce the risk of injury user must read and understand operator's manual before using this product.
	Eye Protection	Wear eye protection when operating this equipment.
	Ricochet	Thrown objects can ricochet and result in personal injury or property damage.
	Sharp Blade	Danger – Keep hands and feet away from blade.
	Keep Bystanders Away	Keep all bystanders at least 50 ft. away.

SYMBOLS

The following signal words and meanings are intended to explain the levels of risk associated with this product.

SYMBOL	SIGNAL	MEANING
	DANGER	Indicates an imminently hazardous situation, which, if not avoided, will result in death or serious injury.
	WARNING	Indicates a potentially hazardous situation, which, if not avoided, could result in death or serious injury.
	CAUTION	Indicates a potentially hazardous situation, which, if not avoided, may result in minor or moderate injury.
	NOTICE	(Without Safety Alert Symbol) Indicates a situation that may result in property damage.

SERVICE

Servicing requires extreme care and knowledge and should be performed only by a qualified service technician. For service we suggest you return the product to your nearest **AUTHORIZED SERVICE CENTER** for repair. When servicing, use only identical replacement parts.

WARNING

To avoid serious personal injury, do not attempt to use this product until you have read this Owner's Manual thoroughly and understand it completely. If you do not understand the warnings and instructions in this Owner's Manual, do not use this product.

Call the Toll-free Helpline (1-866-384-8432) for assistance.

WARNING



The operation of any power tool can result in foreign objects being thrown into your eyes, which can result in severe eye damage. Before beginning power tool operation, always wear safety goggles or safety glasses with side shields and, when needed, a full face shield. We recommend Wide Vision Safety Mask for use over eyeglasses or standard safety glasses with side shields. Always use eye protection which is marked to comply with ANSI Z87.1.

SAVE THESE INSTRUCTIONS

KNOW YOUR TILLER

The safe use of this product requires an understanding of the information on the product and in this Operator's Manual as well as a knowledge of the project you are attempting. Before use of this product, familiarize yourself with all operating features and safety rules.

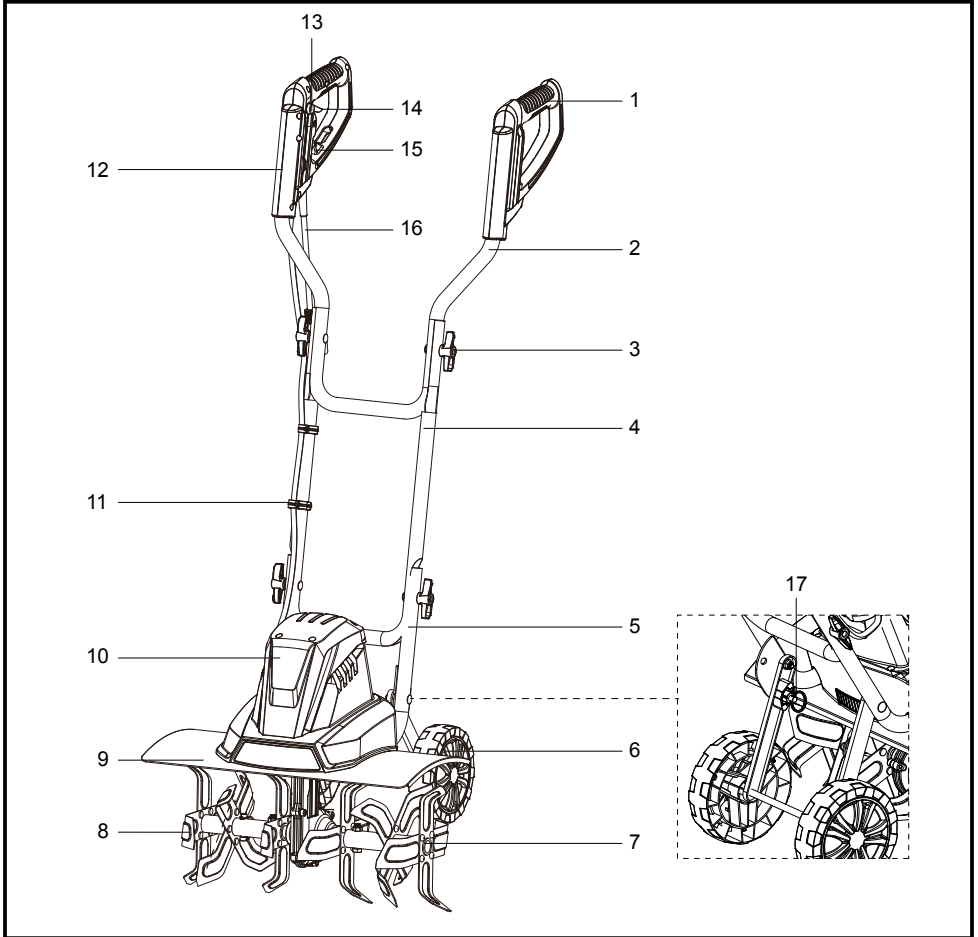

Components

- | | | |
|------------------|---------------------------|-------------------|
| 1. Assist Handle | 6. Wheel | 12. Main Handle |
| 2. Upper Handle | 7. Screws and Screw Bolts | 13. Safety Switch |
| 3. Wing Nut (x4) | 8. Tine | 14. Trigger Lever |
| 4. Middle Handle | 9. Motor Support Plate | 15. Cord Retainer |
| 5. Lower Handle | 10. Motor Housing | 16. Power Cord |
| | 11. Cable Clip (x2) | 17. Locking Pin |

ASSEMBLY

UNPACKING

This product requires assembly.

- Carefully remove the product and any accessories from the box. Make sure that all items listed in the packing list are included.
- Inspect the product carefully to make sure no breakage or damage occurred during shipping.
- Do not discard the packing material until you have carefully inspected and satisfactorily operated the product.
- If any parts are damaged or missing, call Customer Service for assistance (Toll free number 866-384-8432).

YOU WILL NEED (ITEMS NOT SUPPLIED)

- Suitable personal protective equipment
- Philips screwdriver

PACKING LIST

- (1) Tiller
- (1) Upper Handle
- (1) Middle Handle
- (4) Carriage Bolts
- (4) Wing Nuts
- (2) Cable Clips
- (2) Wheels
- (2) Wheel Caps
- (1) Operator's Manual



WARNING

If any parts are damaged or missing do not operate this product until the parts are replaced. Failure to heed this warning could result in serious personal injury.



WARNING

Do not attempt to modify this product or create accessories not recommended for use with this product. Any such alteration or modification is misuse and could result in a hazardous condition leading to possible serious personal injury, and will void the warranty.

ASSEMBLY



WARNING

Do not connect power supply until assembly is complete. Failure to comply could result in accidental starting and possible serious personal injury.



WARNING

Never operate the tool without the proper safety devices in place and working. Never operate the tool with damaged safety devices. Failure to heed this warning can result in serious personal injury.

ASSEMBLING THE WHEEL

1. Remove the pre-assembled split pin and the washer from the axle of the tiller.
2. Place the wheel on the wheel holder. Secure it with the washer and split pin (Fig. 1). Then mount the wheel cap (Fig. 2). Assembly is identical on both sides.

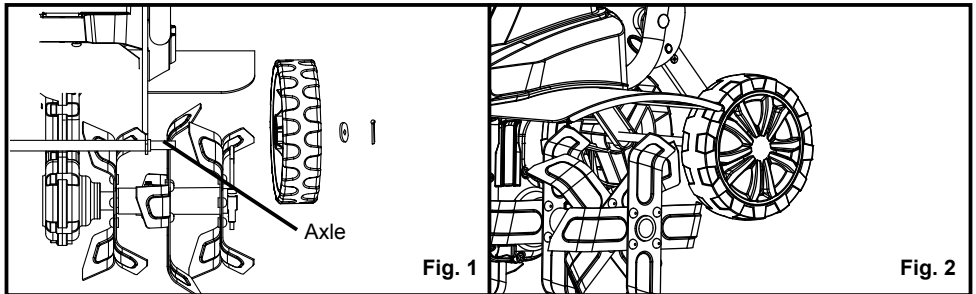

ASSEMBLY

ASSEMBLING THE HANDLES

Connect the upper handle and the middle handle to the lower handle using the carriage bolts and wing nuts (Fig. 3 & 4).

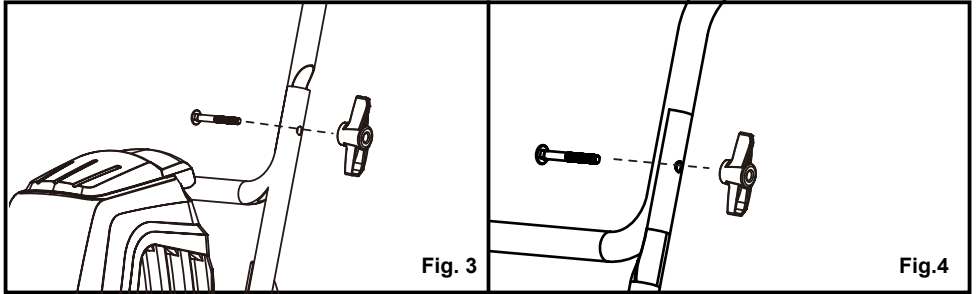

FIXING THE POWER CORD

Mount the cable and the cable clips on the right handle bar (in the working direction) by pushing them on (Fig. 5).

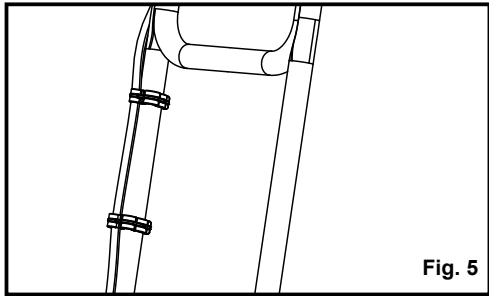

OPERATION



WARNING

Do not use any attachments or accessories not recommended by the manufacturer of this product. The use of attachments or accessories not recommended can result in serious personal injury.



WARNING

Do not switch on the tool until it has been completely assembled. Before switching on the tool, always check the power cord for signs of damage. Only use an undamaged power cord.

NOTE: A damaged power cord is highly dangerous!

STARTING/STOPPING THE TOOL

1. Make sure the wheel frame is raised before you start the tiller. To raise the frame, pull out the locking pin (Step A); rotate the wheel frame upward (Step B); release the locking pin. The wheel frame will be locked in place by the locking pin (Fig. 6 & 7).
2. Secure the extension cord into the cord retainer. The loop of the extension cord must be long enough for the cord retainer to freely slide from one side to the other. Plug the extension cord into the power cord plug on the tiller (Fig. 8).
3. Use the tiller for breaking sod, preparing seed beds, and for cultivating gardens and flower beds. The tiller can also dig small holes for planting saplings or potted plants.
4. Move the tiller to the work area prior to starting the motor.
5. Hold the tiller firmly while starting. The tines will pull the tiller forward during operation.
6. Lower the tines slowly with the guide bar.
7. To start the tiller, first press the safety switch and then pull the trigger lever up (Fig. 9). To stop the tiller, simply release the trigger lever.

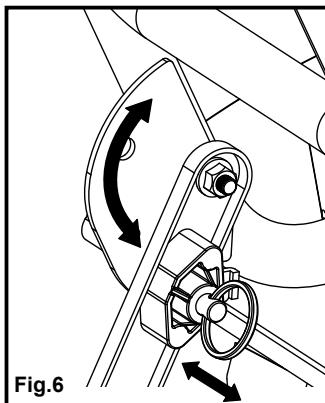

Fig.6

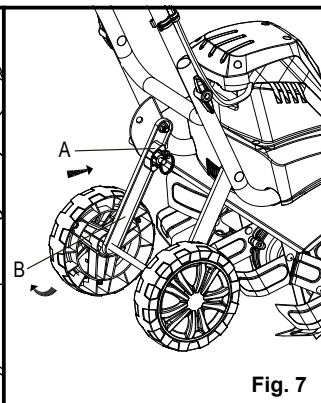

Fig. 7

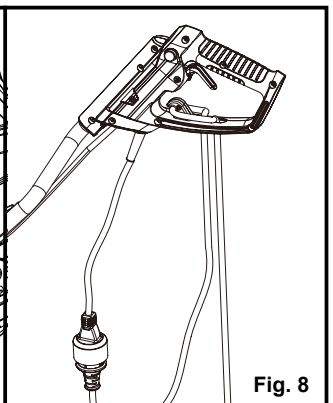

Fig. 8

OPERATION

8. Always ensure that a safety distance (provided by the long handles) is maintained between the user and housing. The safe distance between housing and user given by the handle must always be observed. Be especially careful when digging and changing direction on slopes and inclines.

9. Maintain a solid footing and wear sturdy, non-slip footwear and long trousers. Always dig along the incline (not up and down). For safety reasons, the electric tiller may not be used to dig up inclines whose gradient excess 15 degrees. Use special caution when backing up and pulling the implement (tripping hazard).

TIPS FOR PROPER USE

Always guide the machine slowly and wisely forward. Dig up the area in straight lines. Let the tracks overlap slightly to not miss any stripes to dig. Only use the machine to dig up already loosed soil.

FOR PREPARING SEED BEDS, WE RECOMMEND USING ONE OF THESE TILLING PATTERNS

Tilling Pattern A - Make two passes over area to be tilled, the second at a right angle to the first (Fig. 10).

Tilling Pattern B - Make two passes over area to be tilled, the second overlaps the first (Fig. 10).

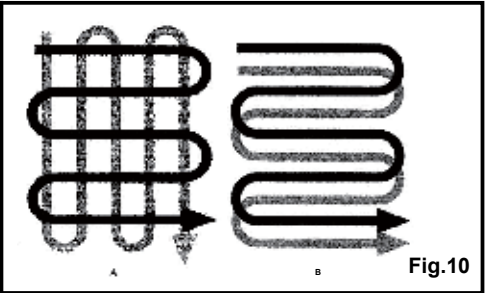
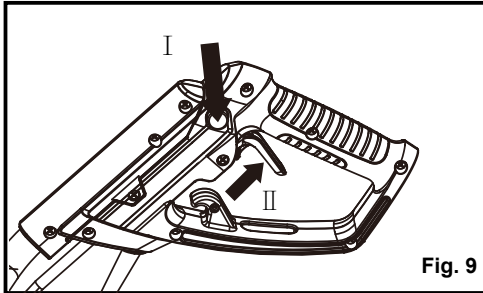

Before use, remove any visible stones or other foreign bodies from the area.



CAUTION

Before moving the tiller from one area to another, switch off the motor and wait for the tines to come to a complete stop. Be careful not to let the tines touch the ground while moving the tiller. The tines as well as the unit itself may be damaged even if the motor is switched off.

OPERATION

CLEARING FOREIGN OBJECTS

During operation, a stone or root could become lodged in the tines, or tall grass or weeds may become wrapped around the tine shaft.

To clear the tines or tine shaft release the trigger lever, wait for the tines to come to a complete stop and unplug the tiller. Dislodge or remove the foreign matter from the tines or tine shaft. To simplify removal of tall grass or weeds from the tine shaft, remove one or more of the tines. See Tine Removal and Installation.

ELECTRICAL CONNECTION

The electrical motor installed is connected and ready for operation. The connection complies with the applicable provisions.

The customer's mains connection as well as the extension cable used must also comply with these regulations.

MAINTENANCE



WARNING

When servicing, use only identical replacement parts. Use of any other parts may create a hazard or cause product damage.



WARNING

Always wear gloves when handling the tiller.



WARNING

Prior to all maintenance and cleaning work always switch off the tool, disconnect the plug from the power socket and wait until the tiller is standing still.

GENERAL MAINTENANCE



WARNING

Do not spray water onto the tool and do not clean it under flowing water. This would result in the danger of an electric shock and the tool could be damaged.



WARNING

Before carrying out maintenance operations, disconnect power supply.

1. Before each use check the extension cord for signs of damage or ageing. Replace the cable if it is cracked, split or otherwise damaged.
 2. A worn out or damaged cutting unit should be replaced by an authorized expert.
 3. Take care that all fastening elements (screws, nuts, etc.) are firmly tightened, so that you can work safely with the electric tiller.
 4. Store the electric tiller in a dry place.
 5. For longer life, all screw-fastened parts, such as wheels and axles should be cleaned and subsequently oiled.
 6. Regular serving of the implement not only secures longer endurance and performance, it also
-

MAINTENANCE

contributes to an accurate and simple dig up for your bed.

7. At the end of the season, carry out a general check of the electric tiller, and remove all residue collected. Before the start of the every season, it is absolutely necessary to check the state of the machine. Contact our customer service if repair work is necessary.



CAUTION

Always clean the tiller after each use. Failure to carry out proper cleaning can result in damage to the tiller or result in poor performance.

1. Keep all safety devices, air vents and the motor housing free of dirt and dust as far as possible.
2. Wipe the equipment with a clean cloth or blow it with compressed air at low pressure.
3. We recommend that you clean the device immediately each time you have finished using it.
4. Clean the equipment regularly with a moist cloth and some soft soap. Do not use cleaning agents or solvents; these could attack plastic parts of the equipment. Ensure that no water can seep into the device. The ingress of water into an electric tool increases the risk of an electric shock.

TINE REMOVAL AND INSTALLATION

Worn tines invite poor performance and overload of the motor. Check tines before each use. Sharpen or replace the tine assemblies with new ones when necessary.

To remove the complete tine assemblies from the shaft, remove the screw from the shaft first. Reverse above steps to install tines.

1. Push the tine roller on the drive shaft of the machine. The tine roller can be mounted left or right side. Be sure that the holes of the tine roller and the drive shaft are aligned.
2. Now the M8 screw is pushed through and secured with the M8 locking nut (Fig. 11).
3. Tighten the lock nut hand-tight using a fork wrench or ratchet with socket (the tools are not included) (Fig. 12).
4. To remove the tine roller, proceed in reverse order.

Tilling Width Adjustable

The machine can be conveniently switched from 6 tines to 4 tines quickly, by offering working width from 18 inches to 12.5 inches, to suffice different working condition.

To adjust the tilling width, remove the screw (Fig. 13) from the shaft first, then remove the tines.

MAINTENANCE

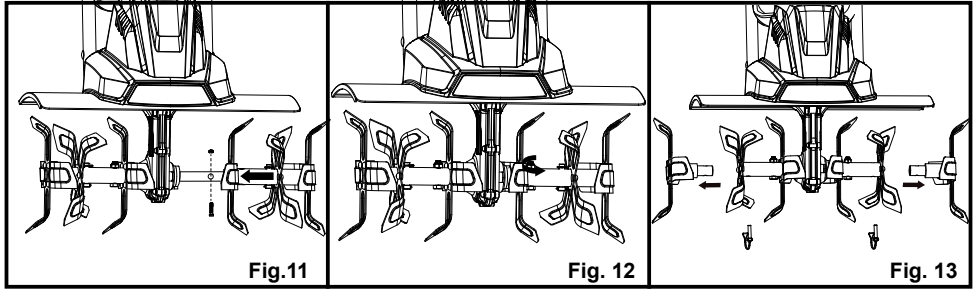

ADDING TRANSMISSION LUBRICANT (FIG.14)

Drain screw plug is located on the right side of transmission housing. Lay the tiller on its left from user's perspective side and clean the transmission of dirt and debris prior to removing the drain screw plug. If necessary, remove tine assemblies to have better access to the drain screw plug. Use a 5mm hex key to unscrew the plug. Empty the oil from the transmission. Fill with a high-quality SAE 30 weight oil, until it begins to seep out around the hole. Reinstall the drain screw plug.

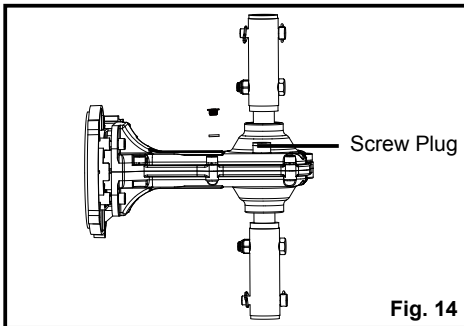

MAINTENANCE

CARBON BRUSHES

In case of excessive sparking, have the carbon brushes checked only by a qualified electrician.



DANGER

The carbon brushes should not be replaced by anyone but a qualified electrician.

TRANSPORT AND STORAGE

Always disconnect the tool from the power supply before transporting and storage! Pull the lock pin. You can now move the wheels to the lower position. Make sure that the lock pin engages again in the lower position.



ATTENTION

The wheels must be fixed in the upper position during the operation!

For storage or transport in the a limited space, proceed as follows:
Open the wing nuts until you can fold the handles forward



ATTENTION

Danger of crushing your fingers.

Now you can transport your machine with the transport handle. So you can storage the machine too.

Storage

Store the device and its accessories in a dark, dry and frost-proof place that is inaccessible to children. The optimum storage temperature is between 5 and 30°C.

Store the electric tool in its original packaging. Cover the electric tool in order to protect it from dust and moisture. Store the operating manual with the electric tool.

During extended periods of storage, ensure that the tiller is protected against corrosion and frost.

At the end of the season, or if the tiller is not being used for longer than a month, wipe over all metal surfaces with an oil impregnated cloth to protect them from corrosion or spray with a fine coat of oil. Fold the handles down, and store the tiller in a suitable place.

TROUBLESHOOTING

Suspected malfunctions are often due to causes that the user can fix themselves.

Therefore check the product using this section. In most cases the problem can be solved quickly.

WARNING

Only perform the steps described within these instructions!

All further inspection, maintenance and repair work must be performed by an authorized service center or a similarly qualified specialist if you cannot solve the problem yourself!

Problem	Possible Causes	Solution
Mower fails to start.	No electricity in plug.	Check line and fuse.
	Cable defective.	Call 866-384-8432 for assistance.
	Switch, switch/plug block defective.	Call 866-384-8432 for assistance.
	Connections to motor or capacitor disconnected.	Call 866-384-8432 for assistance.
Engine performance drops.	Blade roller blocked.	If necessary adjust working depth. Clean housing so that the roller can run freely
	Soil is too firm.	Change working depth.
	Carbon brushes worn out.	Call 866-384-8432 for assistance.
The electric tiller is difficult to check.	Roller badly worn.	Replace roller.
	Roller worn.	Replace roller.
Wrong working depth.	Wrong working depth.	Correct working depth.
	Motor is running, but roller is not rotating.	Gearing defective.

LAWNMASTER® WARRANTY

We take pride in producing a high quality, durable product. This Lawnmaster® product carries a limited two (2) year warranty against defects in workmanship and materials from date of purchase under normal household use. If product is to be used for commercial, industrial or rental use, a 30 day limited warranty will apply. Warranty does not apply to defects due to direct or indirect abuse, negligence, misuse, accidents, repairs or alterations and lack of maintenance. Please keep your receipt/packing list as proof of purchase. This warranty gives you specific legal rights, and you may have other rights, which vary from state to state. For product service call customer service at (866) 384-8432.

Items not covered by warranty :

1. Any part that has become inoperative due to misuse, commercial use, abuse, neglect, accident, improper maintenance, or alteration;
2. The unit, if it has not been operated and/or maintained in accordance with the owner's manual;
3. Normal wear, except as noted below;
4. Routine maintenance items such as lubricants, blade sharpening;
5. Normal deterioration of the exterior finish due to use or exposure.

Transportation Charges : Transportation charges for the movement of any power equipment unit or attachment are the responsibility of the purchaser. It is the purchaser's responsibility to pay transportation charges for any part submitted for replacement under this warranty unless such return is requested in writing by LawnMaster.

SAVE YOUR RECEIPTS. THIS WARRANTY IS VOID WITHOUT THEM.

EXPLODED VIEW

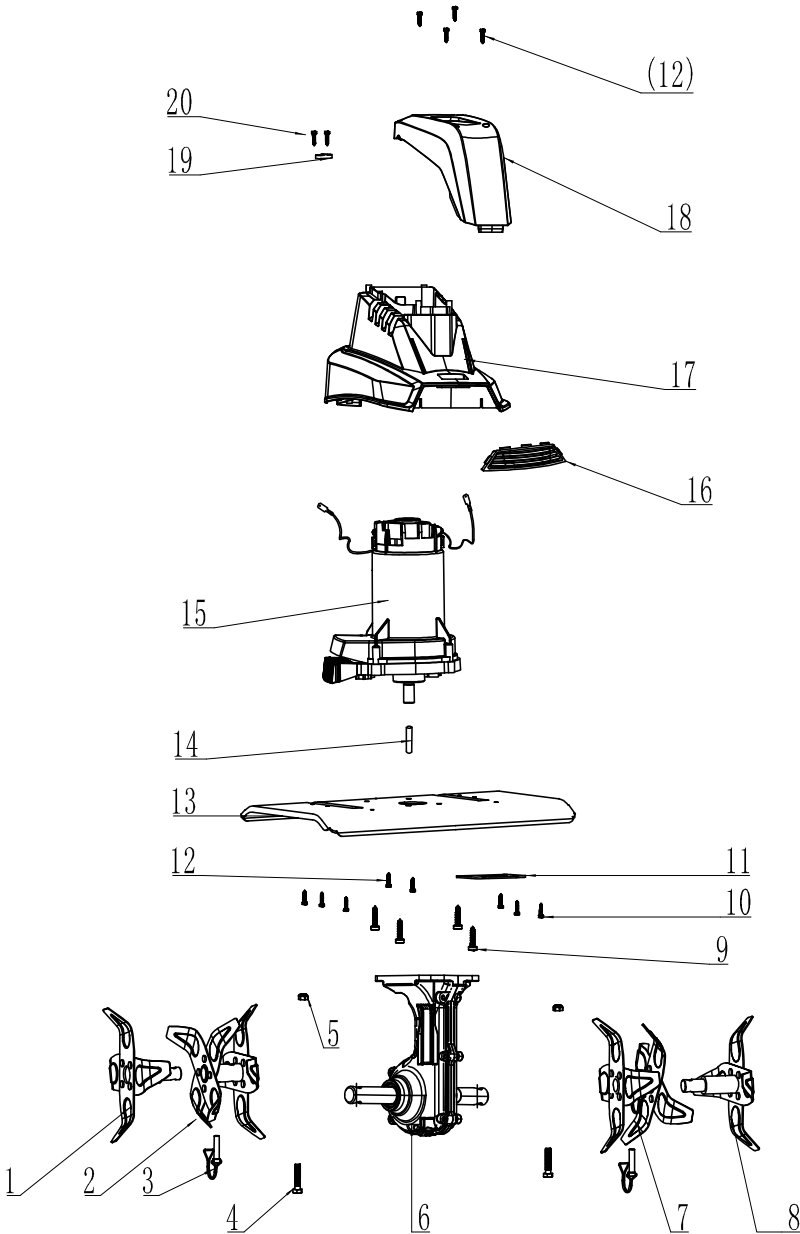

EXPLODED VIEW

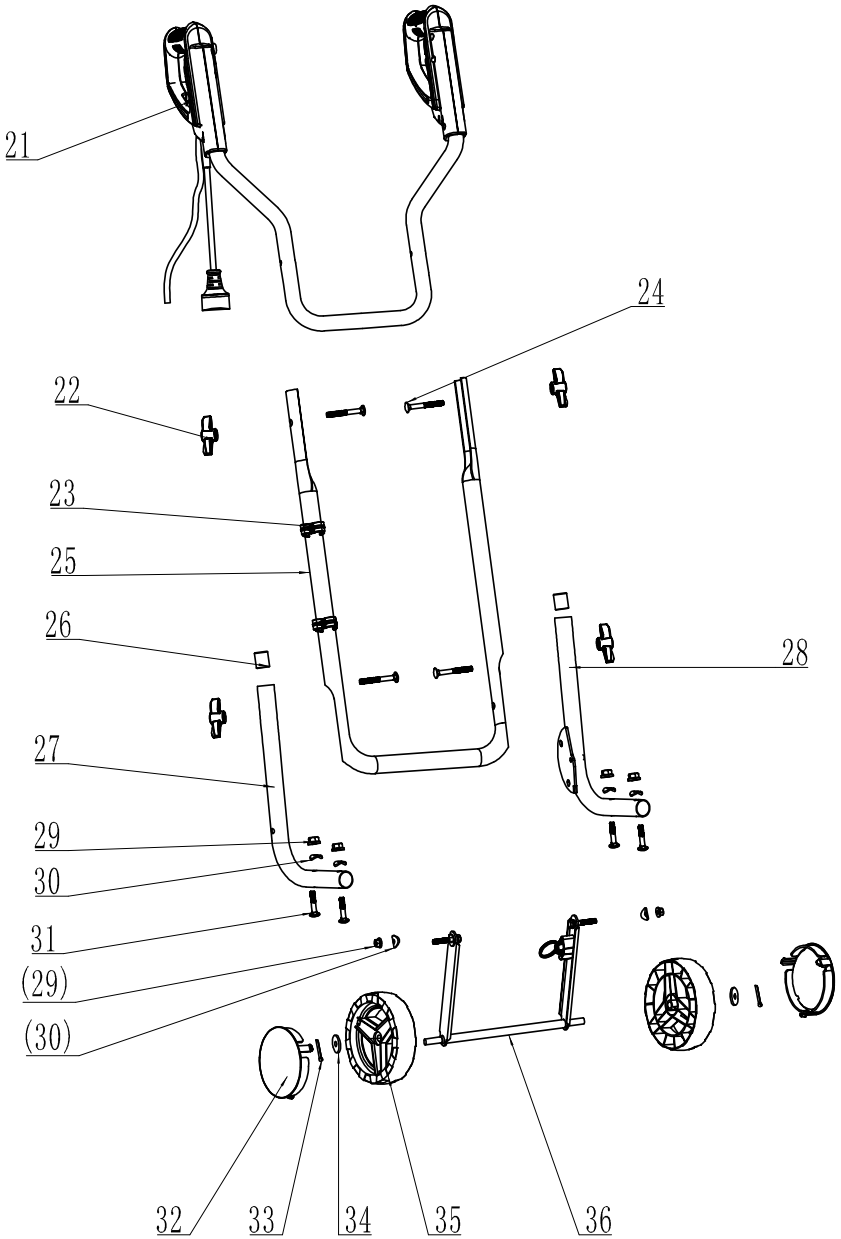

PARTS LIST

Key Number	Drawing Number	Description	Quantity
1	171002101	Tool Free Blade Assembly (Right)	1
2	171002102	Tool Free Blade Assembly (4 pcs Assembly) Right	1
3	171002103	Tool Free Blade Pin Assembly	2
4	171002104	Screw Bolt	2
5	171002105	Locknut	2
6		Gear Box Assembly	1
7	171002107	Tool Free Blade Assembly (4 pcs Assembly) Left	1
8	171002108	Tool Free Blade Assembly (Left)	1
9		Screw	4
10		Screw	6
11		No.1 Sponge	1
12		Screw	6
13		Guard Plate	1
14		Connection Shaft	1
15		Motor Assembly	1
16		Decorative Cover-1	1
17		Main Housing	1
18		Housing Cover-B	1
19		Cable Fix Board	1
20		Screw	2
21		H Shape Switch Assembly	1
22		Knob	4
23		Cable Clamp	2
24		Coach Screw	4
25		No.2 Rod	1
26		Rod Plug	2
27		No. 1 Rod	1
28		No. 1 Rod	1
29		Locknut	6
30		φ6 Wave Washer	6
31		Coach Screw	4

PARTS LIST

Key Number	Drawing Number	Description	Quantity
32	171002132	Wheel Cover	2
33	171002133	R Pin	2
34	171002134	φ10 Flat Key	2
35	171002135	Wheels	2
36		Wheel Axle Assembly	1

Replacement parts highlighted in grey are available for after sales purchase. Replacement of repair or internal parts should only be done by a qualified service professional. Please contact your authorized service dealer or Customer Service at 866-384-8432.

