

LawnMaster[®]

Operator's Manual

14" Electric Mower MEB1114K

Save this manual for future reference

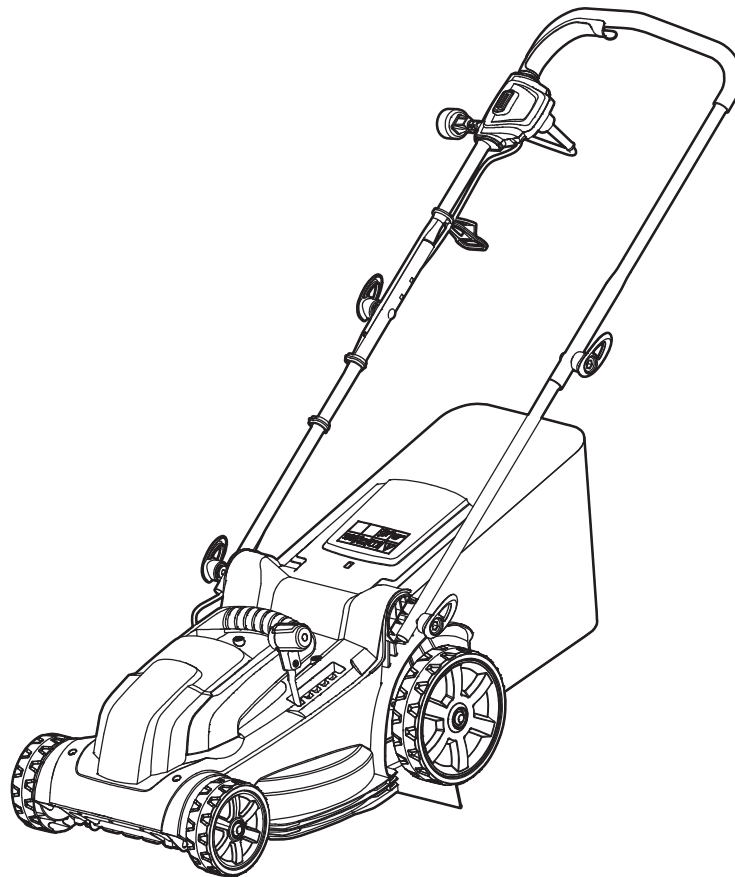

Read all safety rules and instructions carefully before operating this tool.



Intertek

TABLE OF CONTENTS

Section	Page
TABLE OF CONTENTS	2
SPECIFICATIONS	3
IMPORTANT SAFETY INSTRUCTIONS	4-9
SYMBOLS	10-11
KNOW YOUR ELECTRIC MOWER	12
ASSEMBLY	13-17
OPERATION	18-20
MAINTENANCE	21-24
TROUBLESHOOTING	25-26
LAWNMASTER® WARRANTY	27
EXPLODED VIEW	28
PARTS LIST	29
NOTES	30-32

SPECIFICATIONS

ELECTRIC MOWER MEB1114K

Voltage	120 V ~ 60 Hz
Current	11 A
Motor Speed	3300 RPM
Deck Width	15 inch
Cutting Width	14 inch
Cutting Height Adjustment	5 Positions: 1.4 inch -3 inch (35-75 mm)
Collection Bag Capacity	7 gallon (26 liters)
Wheel Size	5 1/2 inch (13.9 cm) / 7 3/4 inch (19.6 cm)
Unit Weight	28 lbs (12.7 kg)

IMPORTANT SAFETY INSTRUCTIONS

INTRODUCTION

This product has many features for making its use more pleasant and enjoyable. Safety, performance, and dependability have been given top priority in the design of this product making it easy to maintain and operate.

WARNING

This symbol indicates important safety instructions. If these instructions are not followed, it could endanger the personal safety and/or property of the operator and others. Read and understand all instructions in this manual before attempting to operate the mower. Failure to comply with these instructions may result in personal injury.

DANGER

This mower was built to be operated according to the rules for safe operation that are contained in this manual. As with any type of power equipment, carelessness or error on the part of the operator can result in serious injury. This mower is capable of amputating body parts and throwing objects. Failure to observe the following safety rules could result in serious injury or death.

WARNING

Use of this mower should be restricted to individuals who have read and understood and will follow the warnings and instructions that are printed in this manual and on the mower.

TRAINING AND PREPARATION

- Read the operating and service instruction manual carefully. Be thoroughly familiar with the controls and the proper use of the tool.
 - Avoid operating the lawn mower in a dangerous environment. Do not use the lawn mower in damp or wet conditions or operate in the rain. Keep a firm hold on the handle and walk, never run.
 - Keep children away. All visitors should be kept a safe distance from work area. Stop the equipment and attachment(s) if anyone enters the working area.
 - Only allow operators, who are responsible, trained, familiar with the instructions, and physically capable to operate the lawn mower.
 - Never allow children to operate a power mower.
 - Keep the area of operation clear of all persons, particularly small children, and pets.
 - Clear the operating area of any objects which could be thrown by or interfere with operation of the tool.
 - Do not operate the lawn mower without the collection bag, discharge chute, or other safety devices in place and functioning properly. Check frequently for signs of wear or deterioration and replace as needed.
 - Wear appropriate personal protective equipment such as safety glasses, hearing protection, and footwear.
 - Dress properly. Do not wear loose clothing or jewelry. They can be caught in moving parts. Use of
-

IMPORTANT SAFETY INSTRUCTIONS

rubber gloves and footwear is recommended when working outdoors.

- This cutting tool is capable of amputating hands and feet and throwing objects. Failure to observe all safety instructions could result in serious injury or death.
- Do not operate the tool while under the influence of alcohol or drugs.
- Use lawn mower for the correct purpose. Do not use lawn mower for any job except that for which it is intended.
- Ground Fault Circuit Interrupter (GFCI) protection should be provided on the circuit(s) or outlet(s) to be used for the lawn mower. Receptacles are available having built-in GFCI protection and may be used for this measure of safety.
- Warning: To prevent electric shock use only with an extension cord suitable for outdoor use, such as SW, SOW, STW, STOW, SJW, SJOW, SJTW, or SJTOW.
- To reduce the risk of electric shock, this appliance has a polarized plug (one blade is wider than the other) and will require the use of a polarized extension cord. The appliance plug will fit into a polarized extension cord only one way.
- If the plug does not fit fully into the extension cord, reverse the plug. If the plug still does not fit, obtain a correct polarized extension cord. A polarized extension cord will require the use of a polarized wall outlet. This plug will fit into the polarized wall outlet only one way. If the plug does not fit fully into the wall outlet, reverse the plug. If the plug still does not fit, contact a qualified electrician to install the proper wall outlet. Do not change the equipment plug, extension cord receptacle, or extension cord plug in any way.
- Make sure your extension cord set is in good condition. When using an extension cord, be sure to use one heavy enough to carry the current your product will draw. For lengths less than 50 feet, No. 14 AWG extension cord should be used. An undersized cord will cause a drop in line voltage resulting in loss of power and overheating. To reduce the likelihood of disconnection of lawn mower cord from the cord set during operating.

OPERATION

- Only operate the equipment in daylight or good artificial light.
- Extinguish all cigarettes, cigars, pipes and other sources of ignition prior to operating the lawn mower.
- Avoid holes, ruts, bumps, rocks, or other hidden hazards. Uneven terrain could overturn the machine, or cause operator to lose their balance or footing.
- Do not put hands or feet near under rotating parts or the lawn mower. Keep clear of the discharge opening at all times.
- Do not direct discharge material toward anyone. Avoid discharging material against a wall or obstruction. Material may ricochet back toward the operator. Stop the blade(s) when crossing gravel surfaces.
- Always wear safety glasses with side shields. Everyday glasses have only impact resistant lenses. They are NOT safety glasses. Following this rule will reduce the risk of eye injury. Use face mask if operation is dusty.
- Wear safety glasses or goggles that are marked to comply with ANSI Z87.1 standard when operating this product.
- Do not leave a running lawn mower unattended. Always park on level ground, disengage the attachment, set parking brake, and stop engine.
- Do not mow in reverse unless absolutely necessary. Always look down and behind before and while backing.

IMPORTANT SAFETY INSTRUCTIONS

- Stop the blade(s) when crossing gravel drives, walks, or roads.
- If the equipment should start to vibrate abnormally, stop the motor and check immediately for the cause. Vibration is generally a warning of trouble.
- Stop the motor and disconnect the plug from power source whenever leaving the equipment, before cleaning the mower housing, and before making any repairs or inspections.
- Shut the motor off and wait until the blade comes to a complete stop before removing the grass catcher or before unclogging the chute.
- Mow across the face of slopes, never up and down. Exercise extreme caution when changing direction on slopes. Do not mow excessively steep slopes.
- Always keep the equipment in gear when going down slopes. Do not coast downhill.
- Avoid starting and stopping on slopes. Avoid making sudden changes in speed or direction. Make turns slowly and gradually.
- Do not wash with a hose; avoid getting water in motor and electrical connections.
- Tragic accidents can occur if the operator is not alert to the presence of children. Children are often attracted to the machine and the mowing activity. Never assume that children will remain where you last saw them.
- Keep children out of the operating area and under the watchful care of a responsible adult other than the operator.
- Do not abuse the cord. Never use the cord to pull the lawn mower or to disconnect the plug from an outlet. Keep cord away from heat, oil, sharp edges, or moving parts. Replace damaged cords immediately. Damaged cords increase the risk of electric shock.
- Do not force lawn mower. It will do the job better and safer at the rate for which it was designed.
- Do not overreach. Keep proper footing and balance at all times.
- Stay alert. Watch what you are doing. Use common sense. Do not operate lawn mower when you are tired.
- Avoid mowing wet grass. Poor footing could cause a slip and fall accident.
- Do not operate machine under any condition where traction, steering, or stability is in question. Tires could slide even if the wheels are stopped.
- Use extra care while operating the equipment with a grass catcher or other attachment(s). They can affect the stability of the machine.
- Thoroughly inspect the area where the equipment is to be used and remove all stones, sticks, wires, bones, and other foreign objects.
- Disengage the self-propelled mechanism or drive clutch on units so equipped before starting the motor.
- Never attempt to make a wheel height adjustment while the motor is running.
- Make a knot as shown, or use one of the plug-receptacle retaining straps or connectors described in this manual.

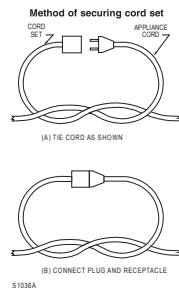

IMPORTANT SAFETY INSTRUCTIONS

MAINTENANCE AND STORAGE

- Use caution when servicing blades. Wrap the blade(s) or wear gloves. Replace damaged blades. Do not repair or alter blade(s).
- Store idle lawn mower indoors. When not in use, lawn mower should be stored in an indoor dry and locked-up place-out of reach of children.
- Maintain lawn mower with care. Keep cutting edges sharp and clean for best and safest performance.
- Check the blade and the engine mounting bolts at frequent intervals for proper tightness.
- Keep all nuts, bolts, and screws tight to be sure the equipment is in safe working condition.
- Check bag frequently for deterioration and wear, and replace worn bags. Check that replacement bags comply with the original manufacturer's recommendations or specifications.
- Replace the blade if it is bent or cracked. An unbalanced blade causes vibration that could damage the motor drive unit or cause personal injury.
- Clean the blade thoroughly and check its balance by supporting it horizontally on a thin nail through its centre hole. The nail should also be in a horizontal position. If either end of the blade rotates downward, remove some metal from the heavy or lower end until the blade is balanced. It is balanced when neither end drops.
- Follow instructions for lubricating and changing accessories.
- Inspect lawn mower cord periodically and if damaged, have it repaired by an authorized service facility. Inspect extension cords periodically and replace if damaged. Keep handles dry, clean, and free from oil and grease.
- Keep guards in place and in working order.
- Keep blades sharp.
- Keep hands and feet away from cutting area.
- Objects struck by the lawn mower blade can cause severe injuries to persons. The lawn should always be carefully examined and cleared of all objects prior to each mowing.
- If lawn mower strikes a foreign object, follow these steps:
 - Stop lawn mower. Release the switch
 - Disconnect from the power supply.
 - Inspect for damage.
 - Repair any damage before restarting and operating the lawn mower.
- When servicing use only identical replacement parts.

ELECTRICAL INFORMATION



WARNING

TO AVOID ELECTRICAL HAZARDS, FIRE HAZARDS, OR DAMAGE TO THE TOOL, USE PROPER CIRCUIT PROTECTION. YOUR LAWN MOWER IS WIRED AT THE FACTORY FOR 120V OPERATION. CONNECT TO A 120 V, 15 A CIRCUIT, AND USE A 15 A TIME-DELAYED FUSE OR CIRCUIT BREAKER. TO AVOID SHOCK OR FIRE, IF THE EXTENSION CORD IS WORN, CUT OR DAMAGED IN ANY WAY, REPLACE IT IMMEDIATELY.

IMPORTANT SAFETY INSTRUCTIONS

DOUBLE INSULATED

This lawn mower has a plug. The lawn mower is double insulated to provide a double □ thickness of insulation between you and the tool's electrical system. All exposed metal parts are isolated from the internal metal motor components with protective insulation.



WARNING

USE ONLY IDENTICAL REPLACEMENT PARTS WHEN SERVICING THE LAWN MOWER TO AVOID INJURY.



WARNING

DOUBLE INSULATION DOES NOT TAKE THE PLACE OF NORMAL SAFETY PRECAUTIONS WHEN OPERATING THIS LAWN MOWER.



CAUTION

ALWAYS MAKE SURE THAT YOUR OUTLET IS PROPERLY GROUNDED. IF UNCERTAIN, HAVE IT CHECKED BY A CERTIFIED ELECTRICIAN.



WARNING

THIS LAWN MOWER IS FOR OUTDOOR USE ONLY. DO NOT EXPOSE TO RAIN OR USE IN DAMP LOCATIONS.

GUIDELINES FOR USING EXTENSION CORDS

USE THE PROPER EXTENSION CORD. Make sure your extension cord is in good condition. When using an extension cord, be sure to use one heavy enough to carry the current your product will draw. An undersized cord will cause overheating. The table below shows the correct size to use depending on cord length and nameplate ampere rating. If in doubt, use the next heavier gauge. The smaller the gauge number, the heavier the cord.

IMPORTANT SAFETY INSTRUCTIONS

Minimum Gauge for Extension Cords (AWG)
(Using 120 V only)

		Total Length of Cord in Feet (meters)			
120V		25ft (7.62m)	50ft (15.24m)	100ft (30.48m)	150ft (45.72m)
Ampere Rating		AWG			
More Than	Not More Than				
0	6	18	16	16	14
6	10	18	16	14	12
10	12	16	16	14	12
12	16	14	12	Not Recommended	

Make sure your extension cord is properly wired and in good electrical condition. Always replace a damaged extension cord or have it repaired by a qualified person before use. Keep extension cords away from sharp objects, excessive heat and damp or wet areas.

Use a separate electrical circuit for your tools. This circuit should comprise a wire of at least 12 gauge and should be protected with a 15 A time-delayed fuse. Before connecting the motor to the power line, make sure the switch is in the OFF position and the electric current is identical to that stamped on the motor nameplate. Running at a lower voltage will damage the motor.



WARNING

SAVE THESE INSTRUCTIONS.









ALTHOUGH THIS LAWN MOWER IS DOUBLE INSULATED, THE EXTENSION CORD AND RECEPTACLE MUST STILL BE GROUNDED WHILE IN USE TO PROTECT THE OPERATOR FROM ELECTRICAL SHOCK.

SAVE THESE INSTRUCTIONS

Refer to them frequently and use them to instruct others who may use this product. If you loan someone this product, loan them these instructions also.



SYMBOLS

Some of the following symbols may be used on this product. Please study them and learn their meaning. Proper interpretation of these symbols will allow you to operate the product better and safer.

SYMBOL	NAME	DESIGNATION/EXPLANATION
V	Volts	Voltage
A	Amperes	Current
Hz	Hertz	Frequency(cycles per second)
W	Watt	Power
hrs	Hours	Time
	Class II Construction	Double-insulated construction
	Safety Alert	Precaution that involves your safety.
	Read The Operator's Manual	To reduce the risk of injury, user must read and understand Operator's Manual before using this product.
	Do not mow up and down slopes!	To avoid the risk of injury do not mow up and down slopes. Always mow across slopes. (Angle $\leq 15^\circ$)
	Keep all persons and pets at a safe distance from the mower while operating!	To avoid the risk of injury to bystanders keep all persons and pets at a safe distance from the mower while operating.
	Keep hands and feet clear of mower deck and discharge opening at all times!	Rotating blades can cause serious injury. Keep hands and feet clear of mower deck and discharge opening at all times. Always be sure blade has stopped after releasing switch lever and unplugging before removing and replacing collection bag, cleaning, servicing, transporting or lifting the mower.
	Stay behind the handle when the motor is running!	Objects struck by mower blade can cause serious injury. Stay behind the handle when the moto is running. Always ensure persons and pets are clear of the discharge from the mower while operating.
	Keep hands and feet away	Danger: Keep hands and feet away.
	Cutting Width	Cutting diameter

SYMBOLS

The following signal words and meanings are intended to explain the levels of risk associated with this product.

SYMBOL	SIGNAL	MEANING
	DANGER	Indicates an imminently hazardous situation, which, if not avoided, will result in death or serious injury.
	WARNING	Indicates a potentially hazardous situation, which, if not avoided, could result in death or serious injury.
	CAUTION	Indicates a potentially hazardous situation, which, if not avoided, may result in minor or moderate injury.
	NOTICE	(Without Safety Alert Symbol) Indicates a situation that may result in property damage.

SERVICE

Service requires extreme care and knowledge and should be performed only by a qualified service technician. For service, we suggest you return the product to your nearest **SERVICE CENTER** for repair. When servicing, use only identical replacement parts.



WARNING

To avoid serious personal injury, do not attempt to use this product until you read thoroughly and understand completely the Operator's Manual.

If you do not understand the warnings and instructions in the Operator's Manual, do not use this product. Please call customer service for assistance (866) 384-8432.

KNOW YOUR ELECTRIC MOWER

The safe use of this product requires an understanding of the information on the product and in this Operator's Manual as well as a knowledge of the project you are attempting. Before use of this product, familiarize yourself with all operating features and safety rules.

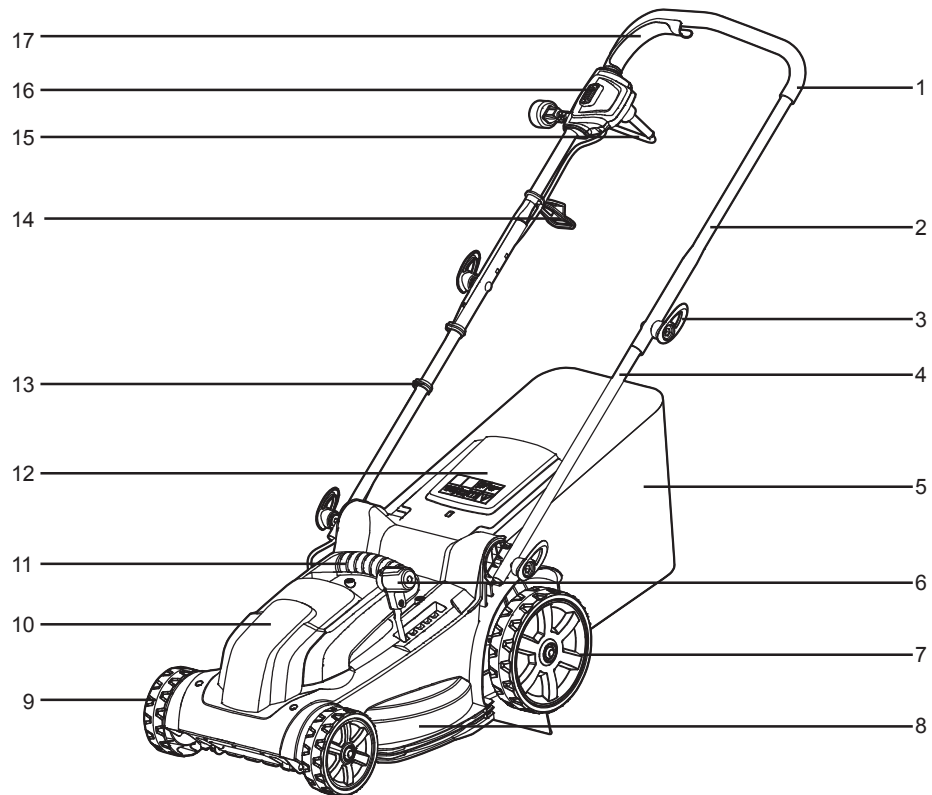

Components

- | | | |
|------------------------------------|-------------------|----------------------------|
| 1. Foam Grip | 7. Rear Wheel | 13. Cable Clip (×2) |
| 2. Upper Handle | 8. Deck | 14. Cord Retainer |
| 3. Locking Knob (×4) | 9. Front Wheel | 15. Power Cord |
| 4. Lower Handle | 10. Motor Housing | 16. Safety Switch Button |
| 5. Grass Collection Bag | 11. Carry Handle | 17. Start/Stop Bale Switch |
| 6. Cutting Height Adjustment Lever | 12. Safety Flap | |

ASSEMBLY

UNPACKING

This product requires assembly.

- Carefully remove the product and any accessories from the box. Make sure that all items listed in the packing list are included.
- Inspect the product carefully to make sure no breakage or damage occurred during shipping.
- Do not discard the packing material until you have carefully inspected and satisfactorily operated the product.
- If any parts are damaged or missing, please call customer service for assistance (866) 384-8432.

YOU WILL NEED (ITEMS NOT SUPPLIED)

- Suitable Personal Protective Equipment.

PACKING LIST

- (1) Lawn Mower
- (1) Grass Collection Bag Assembly (Bag & Metal Frame)
- (1) Upper Handle Assembly
- (2) Lower Handle Assembly
- (4) Locking Knobs
- (4) Washers
- (2) Bolts
- (2) Cable Clips
- (1) Cord Retainer
- (1) Operator's Manual



WARNING

If any parts are damaged or missing do not operate this product until the parts are replaced. Failure to heed this warning could result in serious personal injury.



WARNING

Do not attempt to modify this product or create accessories not recommended for use with this product. Any such alteration or modification is misuse and could result in a hazardous condition leading to possible serious personal injury, and will void the warranty.

ASSEMBLY

WARNING

Do not connect power supply until assembly is complete. Failure to comply could result in accidental starting and possible serious personal injury.

WARNING

Never operate the mower without the proper safety devices in place and working. Never operate the mower with damaged safety devices. Failure to heed this warning can result in serious personal injury.

ASSEMBLING THE LOWER HANDLE (See Figs. 1)

- Slightly spread the ends of the lower handle and place them on the threaded bolts on the right and left of the housing. Fasten the lower handle using the washers and locking knobs (Fig. 1).

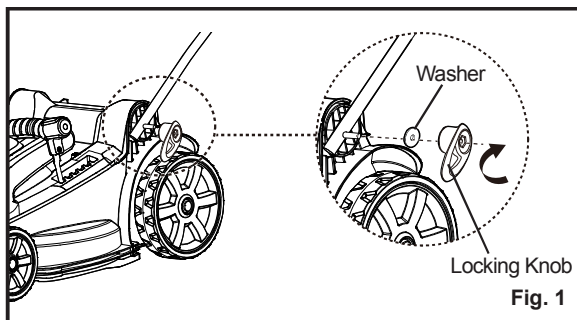

ASSEMBLING THE UPPER HANDLE (See Figs. 2-3)

- The cord retainer helps keep the extension cord connection secure during mower operation. Ensure the cord retainer is positioned over the upper handle.
- Fix the upper handle using the bolts, washers and the locking knobs (Fig. 2). The upper handle can be fixed on three different heights.

ASSEMBLY

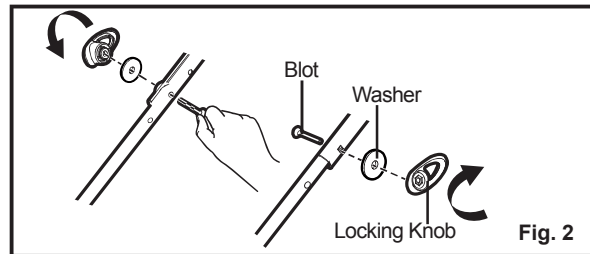

- Secure the control cable with the cable clips (Fig. 3).

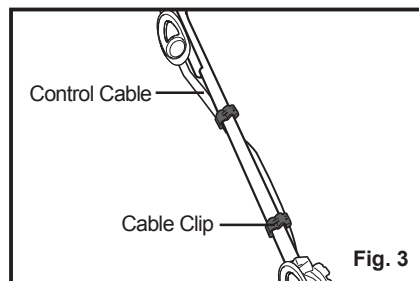

ASSEMBLING THE GRASS COLLECTION BAG (See Figs. 4-5)

- Check the grass collection bag before assembling to make sure there is no damage.
- Pull the grass collection bag over the metal frame as shown (Fig. 4).
- Pry open the soft plastic clamping sleeves and insert the metal frame into the sleeves. Ensure all sleeves are properly clamped on the frame.
- The completely assembled grass collection bag is shown as below (Fig. 5).

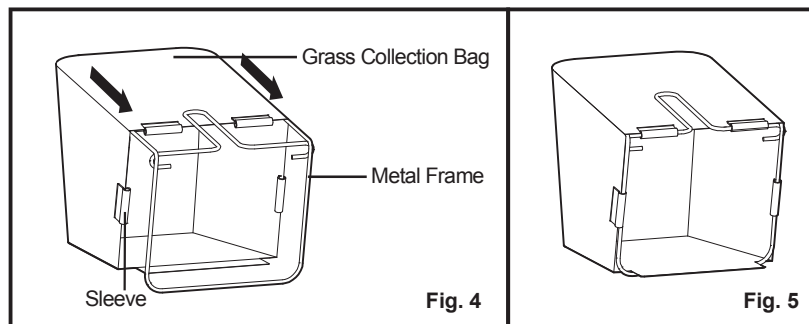

ASSEMBLY

INSTALLING / REMOVING THE GRASS COLLECTION BAG (See Figs. 6-7)

NOTE: The safety flap is spring operated. Ensure you have a firm grip when opening and closing to avoid personal injury.

Installing the grass collection bag:

- Lift the rear safety flap (9) and hold it in position (Fig. 6).
- Lift the grass collection bag by its handle, and align the rods of grass collection bag with the hooks under rear safety flap (Fig. 7).
- Release the rear safety flap.
- Make sure both rods are firmly seated on the holder hooks and the safety flap rests firmly against the top of the grass collection bag.

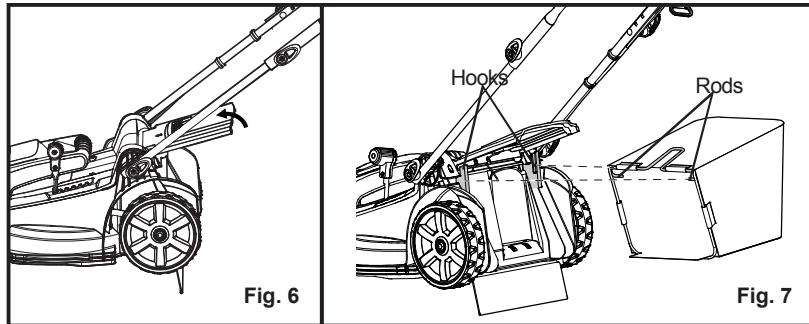

Removing the grass collection bag:

- Lift the rear safety flap and hold it in position.
- Lift the grass collection bag by its handle, and remove it from the mower.
- Release the rear safety flap.

NOTE: Under normal usage, bag material is subject to wear. To reduce the risk of injury, frequently inspect the bag assembly and replace if there are any signs of wear or deterioration.

ASSEMBLY

ADJUSTING THE CUTTING HEIGHT (See Fig. 8)

WARNING

Do not at any time make any adjustment to the lawn mower without first stopping the motor and removing the safety key. Keep your feet away from the mower deck when adjusting its height.

When shipped, the rear wheels of the mower are set in the transportation position. Before using the mower for the first time, adjust the cutting position to the height best suited for your lawn. It is recommended to use the highest position for cutting, and then gradually lower the position for cutting. The mower can be set to 5 cutting heights between 1.4" (35 mm) and 3" (75 mm). Choose the proper cutting height according to the types and conditions of the grass.

To set the cutting height:

- To raise the cutting height, grasp the cutting height adjustment lever and move it toward the back of the mower (Fig. 8).
- To lower the cutting height, grasp the cutting height adjustment lever and move it toward the front of the mower (Fig. 8).

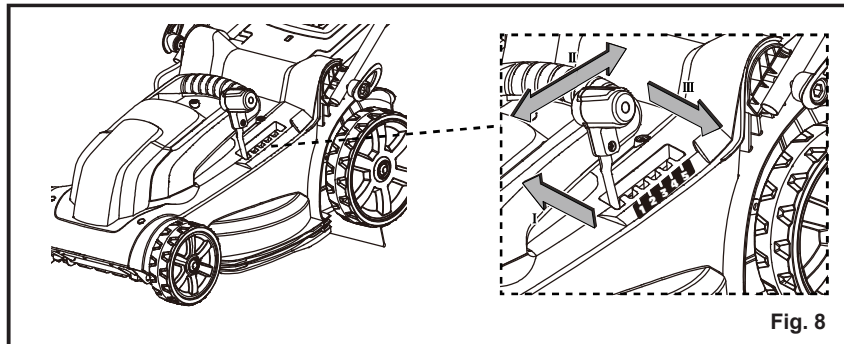

Fig. 8

OPERATION

WARNING

Do not allow familiarity with this type of product to make you careless. Remember that a careless fraction of a second is sufficient to inflict serious injury.

WARNING

Always wear safety goggles or safety glasses with side shields when operating this product. Failure to do so could result in objects being thrown into your eyes, resulting in possible serious injury.

WARNING

Do not use any attachments or accessories not recommended by the manufacturer of this product. The use of attachments or accessories not recommended can result in serious personal injury.

STARTING/STOPPING THE MOWER (See Figs. 9-10)

- Attach the outlet end of an extension cord to the plug on the rear of the mower power cord.
NOTE: Use only an approved outdoor extension cord as described previously in this manual.
- Make a loop in the extension cord. From the right side, pass the loop through the hole in the back of cord retainer and place it around the hook (Fig. 9).

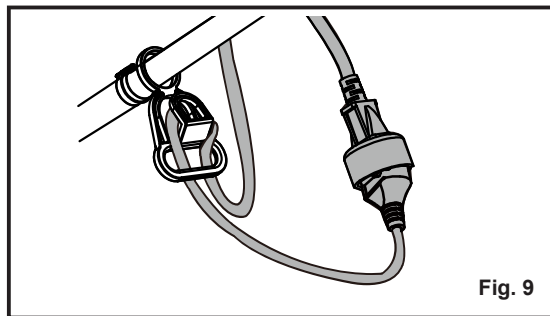

- Press down the safety switch button and hold it. Pull the start/stop bale switch toward the mower handle and release the safety switch button once started. Continue to hold the start/stop bale switch against the mower handle as you mow (Fig. 10).
- To stop the mower, release the start/stop bale switch.

NOTE: A high-pitched noise and sparking may occur as the electric motor decelerates. This is normal.

OPERATION

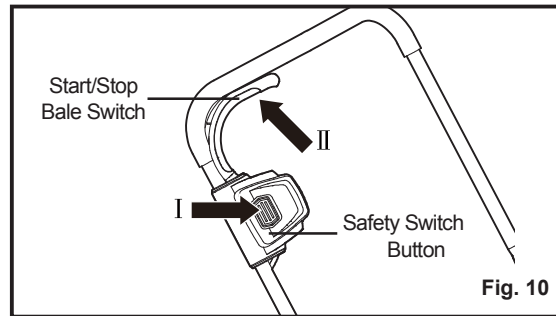

MOWING TIPS (See Fig. 11)

- Make sure the lawn is clear of stones, sticks, wires, and other objects that could damage the lawn mower blades or motor. Such objects could be accidentally thrown by the mower in any direction and cause serious personal injury to the operator and others.
- To reduce the chances of disconnecting the lawn mower from the extension cord, be sure to use the cord retainer provided.
- For a healthy lawn, always cut off one-third or less of the total length of the grass.
- When cutting heavy grass, reduce walking speed to allow for more effective cutting and a proper discharge of the clippings.
- Do not cut wet grass. It will stick to the underside of the deck and prevent proper mulching of grass clippings.
- New or thick grass may require a narrower cut.
- Clean the underside of the mower deck after each use to remove grass clippings, leaves, dirt, and any other accumulated debris.
- Mow in slight overlapping rows. The most effective pattern for mowing lawns is in straight lines along one of the sides. This will keep the rows even and ensure that the lawn is cut without missing any spots (Fig. 11).

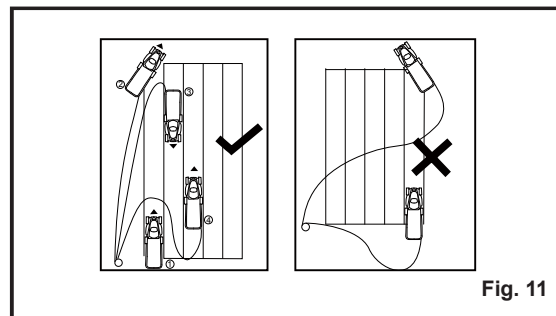
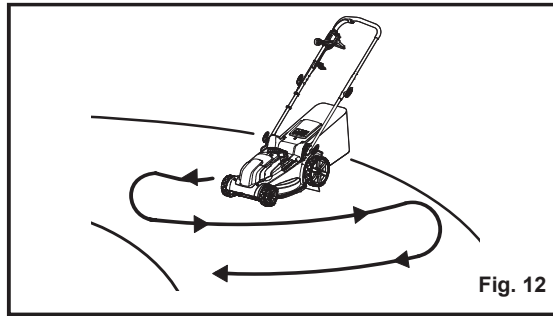

Fig. 11

OPERATION

MOWING ON A SLOPE (See Fig. 12)

- Slopes are a major factor related to slip and fall accidents that can result in severe injury. Mowing on slopes requires extra caution. If you feel uneasy on a slope, do not mow it. For your safety, do not attempt to mow slopes greater than 15 degrees.
- Mow across the face of slopes, not up and down. Exercise extreme caution when changing direction on slopes.
- Watch for holes, ruts, rocks, hidden objects, or bumps which can cause you to slip or trip. Tall grass can hide obstacles. Remove all objects such as rocks, tree limbs, etc., which could be tripped over or thrown by the blade.
- Always be sure of your footing. A slip and fall can cause serious personal injury. If you feel you are losing your balance, release the start/stop bale switch immediately.
- Do not mow near drop-offs, ditches, or embankments; you could lose your footing or balance.



AFTER USE

- Switch the product off, disconnect it from the power supply and let it cool down.
- Check, clean and store the product as described below

MAINTENANCE

WARNING

When servicing, use only identical replacement parts. Use of any other parts may create a hazard or cause product damage.

WARNING

Always wear safety goggles or safety glasses with side shields during power tool operation or when blowing dust. If operation is dusty, also wear a dust mask.

GENERAL MAINTENANCE

Avoid using solvents when cleaning plastic parts. Most plastics are susceptible to damage from various types of commercial solvents and may be damaged by their use. Use clean cloths to remove dirt, dust, oil, grease, etc.

WARNING

Do not use any attachments or accessories not recommended by the manufacturer of this product. The use of attachments or accessories not recommended can result in serious personal injury.

- Do not at any time make any maintenance to the lawn mower without first switching the mower off, disconnecting it from the power supply and letting the mower cool down.
 - Periodically check all nuts and bolts for proper tightness to insure safe operation of the mower.
 - Remove any buildup of grass and leaves on or around the motor cover. Wipe the mower clean with a dry cloth occasionally. Do not use water.
-

WARNING

Always protect hands by wearing heavy gloves and/or wrapping the cutting edges of the blade with rags and other material when performing blade maintenance. Failure to heed this warning could result in serious personal injury.

WARNING

Before performing any maintenance, make sure the mower is unplugged from the power supply. Failure to heed this warning could result in serious personal injury.

MAINTENANCE

REPLACING THE MOWER BLADE (See Figs. 13-14)

- Stop the motor and allow the blade to come to a complete stop. Disconnect the power supply.
- Turn the mower on its side.
- Wedge a block of wood between the blade and the mower deck in order to prevent the blade from turning when the nut is being removed (Fig. 13).
- Loosen the blade nut using a 14 mm wrench or socket (not provided) (Fig. 13).
- Remove the blade nut and blade.
- Make certain the fan assembly is pushed completely against the motor shaft.
- Place the new blade on the shaft against the fan assembly. Make sure it is installed with the curved ends pointing up toward the mower deck and not down toward the ground.
- Thread the blade nut on the shaft and finger tighten.
- Torque the blade nut down using a torque wrench (not provided) to ensure the bolt is properly tightened (Fig. 14).

NOTE: Make certain all parts are replaced in the exact order in which they were removed.

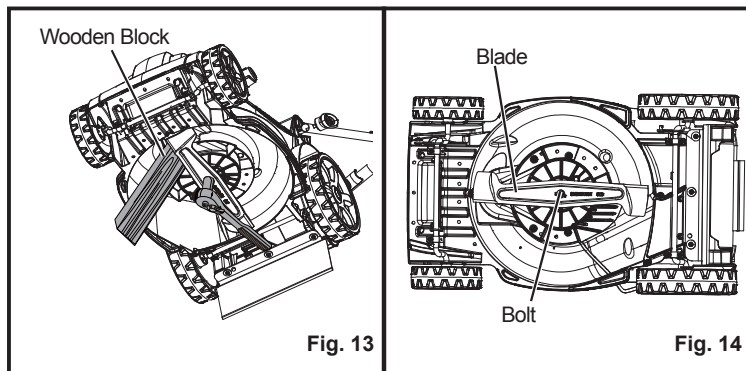

SHARPENING THE BLADE (See Fig. 15)

For best mowing performance, the mower blade must be kept sharp. A dull blade does not cut grass evenly and overloads the motor. Under normal circumstances, sharpening the blade twice during the mowing season is usually sufficient. However, if your lawn has sandy soil, more frequent sharpening may be required.

- Following the instructions in the Replacing the Mower Blade section, remove the mower blade. DO NOT attempt to sharpen the blade while it is attached to the mower.
- Using a fine-tooth file or sharpening stone, sharpen cutting edges on both ends of the blade, removing equal amounts of material from both ends (Fig. 15).

MAINTENANCE

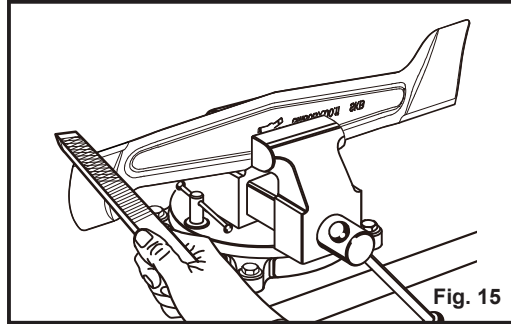

WARNING

When removing, inspect the blade carefully. If the blade is bent or damaged, replace immediately with a new blade. Failure to replace a bent or damaged blade could cause an accident resulting in possible serious injury.

BALANCING THE BLADE (See Fig. 16)

When sharpening, care should be taken to keep the blade balanced. An unbalanced blade will cause excessive vibration when the mower is running. This vibration will eventually cause damage to the mower, especially the motor.

To check the blade balance:

- Clamp a screwdriver horizontally in a vise as shown.
NOTE: If a vise is not available, a straight nail can also be used.
- Place the center hole of blade on the screwdriver (or nail) shank.
- If blade is balanced, it will remain in a horizontal position. If either end of the blade drops downward, sharpen the heavy side until the blade is balanced.

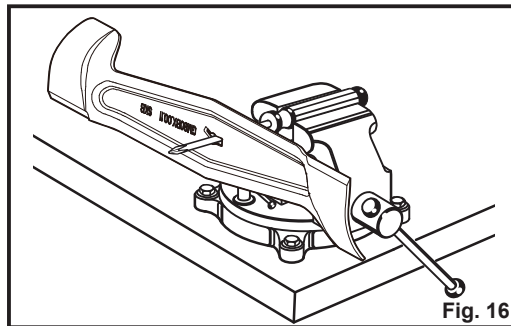

MAINTENANCE

STORING THE MOWER (See Figs. 17-18)

- Disconnect the mower from the power supply.
- Turn mower on its side and clean grass clippings that have accumulated on the underside of the mower deck.
- Wipe the mower clean with a dry cloth.
- Check all nuts, bolts, knobs, screws, fasteners, etc., for tightness.
- Inspect moving parts for damage, breakage, and wear. Have repairs made on any damaged or missing parts.
- Store mower indoors in a clean, dry place out of the reach of children.
- Do not store near corrosive materials such as fertilizer or rock salt. To lower the handle before storing:
 - Remove and clean the grass collection bag.
 - Fully loosen the locking knobs on the sides of the handle and fold the upper handle down (Fig. 17).
 - To save the space, the grass collection bag can be put on the mower (Fig. 18).

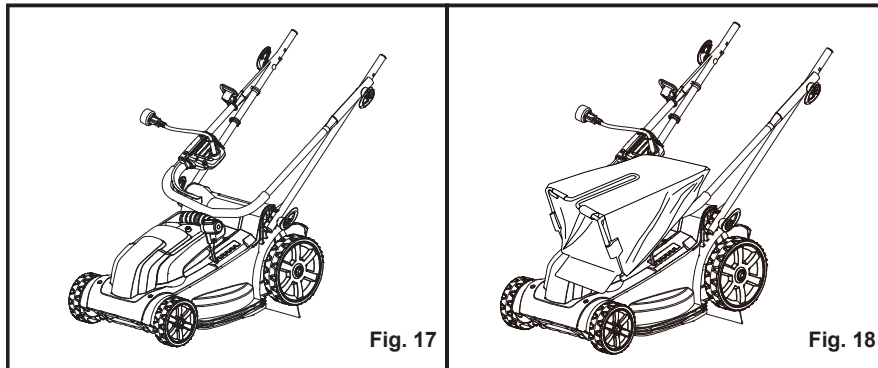

TROUBLESHOOTING

Suspected malfunctions are often due to causes that the user can fix themselves.
Therefore check the product using this section. In most cases the problem can be solved quickly.

WARNING

Only perform the steps described within these instructions!

All further inspection, maintenance and repair work must be performed by an authorized service center or a similarly qualified specialist if you cannot solve the problem yourself!

PROBLEM	POSSIBLE CAUSE	SOLUTION
Mower fails to start.	The carriage bolts are not seated properly.	Adjust the height of the handle and make sure the carriage bolts are seated properly.
	The locking knobs are not tightened.	Tighten locking knobs.
	The extension cord is not connected to the mower plug.	Reconnect the cord and use the cord retainer to keep the cord close to the motor/blade control.
	The extension cord is not connected to the power source.	Connect the extension cord to a live 120 V AC, 60 HZ AC receptacle.
	Tripped circuit breaker in the house.	Reset house circuit breaker. If it trips again, call a qualified electrician.
	The switch is defective.	Replace the switch. Please call customer service for assistance (866) 384-8432.
Mower cuts unevenly.	Lawn is rough or uneven.	Check the mowing area.
	Cutting height is not set properly.	Set the mower at a higher position.
	Dull blade.	Sharpen or replace the blade.
Mower does not mulch properly.	Wet grass clippings sticking to the underside of the deck.	Wait until the grass dries before mowing.

TROUBLESHOOTING

PROBLEM	POSSIBLE CAUSE	SOLUTION
Mower is hard to push.	High grass and low cutting height. Rear of mower housing and blade dragging in heavy grass.	Raise the cutting height.
Mower vibrates overly and makes excessive noise.	The cutting blade is not assembled securely.	Tighten the blade bolts.
	The blade is not balanced.	Sharpen and balance the blade following instructions in this manual (see page 22-23). Or replace the blade.
	The motor shaft is bent.	Stop the mower and unplug it from the power supply. Have the mower inspected and repaired by an authorized service center before restarting.

LAWNMASTER® WARRANTY

We take pride in producing a high quality, durable product. This Lawnmaster® product carries a limited two (2) year warranty against defects in workmanship and materials from date of purchase under normal household use. If product is to be used for commercial, industrial or rental use, a 30 day limited warranty will apply. Warranty does not apply to defects due to direct or indirect abuse, negligence, misuse, accidents, repairs or alterations and lack of maintenance. Please keep your receipt/packing list as proof of purchase. This warranty gives you specific legal rights, and you may have other rights, which vary from state to state. For product service call customer service at (866) 384-8432.

Items not covered by warranty :

1. Any part that has become inoperative due to misuse, commercial use, abuse, neglect, accident, improper maintenance, or alteration;
2. The unit, if it has not been operated and/or maintained in accordance with the owner's manual;
3. Normal wear, except as noted below;
4. Routine maintenance items such as lubricants, blade sharpening;
5. Normal deterioration of the exterior finish due to use or exposure.

Transportation Charges : Transportation charges for the movement of any power equipment unit or attachment are the responsibility of the purchaser. It is the purchaser's responsibility to pay transportation charges for any part submitted for replacement under this warranty unless such return is requested in writing by LawnMaster.

SAVE YOUR RECEIPTS. THIS WARRANTY IS VOID WITHOUT THEM.

EXPLODED VIEW

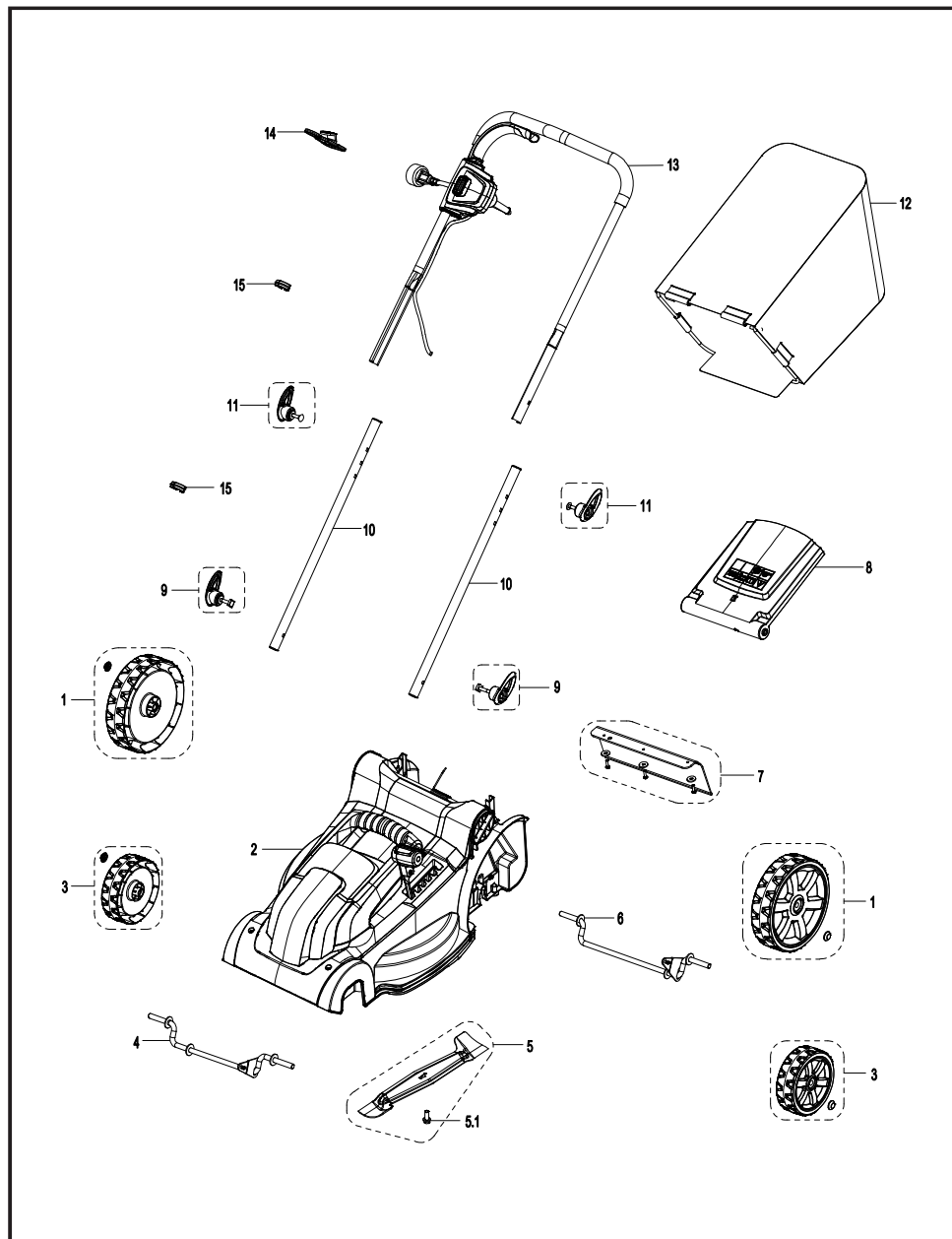

PARTS LIST

Key Number	Part Number	Description	Quantity
1		Rear Wheel Assembly	2
2		Mower Assembly	1
3		Front Wheel Assembly	2
4		Front Wheel Axle Assembly	1
5	111030113	Blade Assembly	1
5.1		Blade Bolt	1
6		Rear Axle Assembly	1
7		Safety Flap Assembly	1
8		Safety Door	1
9		Lower Handle Locking Knob	2
10		Lower Handle Assembly	2
11		Upper Handle Locking Knob	2
12	111309109	Grass Collection Bag	1
13		Upper Handle Assembly	1
14		Cord Retainer	1
15		Cable Clip	2

Replacement parts highlighted in grey are available for after sales purchase. Replacement of repair or internal parts should only be done by a qualified service professional. Please contact your authorized service dealer or Customer Service at 866-384-8432.

This image shows a single sheet of white paper with horizontal ruling lines. The lines are evenly spaced and run across the width of the page. There are no margins, text, or other markings on the paper.

This image shows a single sheet of white paper with horizontal ruling lines. The lines are evenly spaced and run across the width of the page. There are no margins, text, or other markings on the paper.

[illegible]